

CATCHWELL

<http://www.catchwell.com>

CW31 User Manual



Device Notices

Catchwell, Inc. All rights reserved. Without prior written consent from Catchwell, no part of this manual can be replicated nor copied by any means, electronic or mechanical, such as digital media or paper, etc.

The contents of this manual can be subject to change without prior notice. Software will be provided literally "as is." All software including firmware applications have been appropriately licensed. In regard to all the provided software, Catchwell assigns users non-transferable, non-exclusive license. Except for the cases set forth hereunder, a user is not allowed to transfer the license to a third party in the form of sublicense or by other means. All or partial modification, merge, integration of the software except for the cases allowed by the copyright laws are prohibited. Hereby, a user shall agree not to decompile, disassemble, decode, or reverse engineer all or a part of the licensed software without prior consent from Catchwell. Catchwell holds rights to modify the device or software in order to improve the stability, features, and design of the device. Catchwell does not accept any liability whatsoever for any incidental or consequential loss or damage arising from the use of applications, devices, circuits or other software mentioned in this manual. Catchwell and its logo are trademarks of Catchwell, Inc. Microsoft, Windows CE, Windows Mobile, Bluetooth, Wi-Fi, WCDMA, etc. are all the properties of their respective owners.

Catchwell™

B-405, Bundang Techno Park, 148, Yatap-dong, Bundang-gu, Seongname-si, Gyeonggi-do

<http://www.catchwell.com>

Information on this Manual

The contents of this manual contain the instructions how to use the Window Mobile operating system that runs on CW31.

The illustrations contained in this manual may be different from the actual device.

Technical Support

If you find any problem with the device, please contact Technical Support Team of Catchwell (e-mail : support@catchwell.com). Or you can visit our Q&A bulletin board at our web site (<http://www.catchwell.com>) for further inquiry.

When you make an inquiry, please have the followings ready:

- Serial number of the device
- Model number
- Information of the supplier where you purchase the device, and a user's contact information

Catchwell does not accept liability for damages that may result from improper packaging when a user sends the device to Catchwell. If you purchased the device from a supplier of Catchwell, please contact the supplier for device support.

■ Manual revision history

Changes to the original manual are listed below:

Change	Date	Description

Safety Information

The following is the information for the safety of users and for preventing the device from being damaged. Please read the following carefully and use the device accordingly.

■ Power usage

- In the event of abnormal sounds, smells, or smoke, please contact the supplier for customer support after unplugging the device from the power outlet and removing the battery.
- Do not touch the power plug with wet hands.
- Do not charge the battery while thundering or lightening, and unplug the cradle from the power outlet.
- Do not use the device in humid or wet places.
- Only use the provided batteries, power adaptor, and cradle.

■ Battery

- When you use the battery for the first time, please use the battery after fully charging it.
- When the surface of the device is wet, turn off the device and remove the battery then wipe off water with a cloth or a dry towel before use.
- Use the cradle when you charge the battery.
- Be careful to prevent the surface of a battery from being in contact with metallic objects.
- Do not disassemble or open, crush, bend or deform, puncture, or shred the battery.
- Do not dispose of batteries in fire.

■ Usage and storage

- Do not store the device inside a car to avoid any possible loss by theft.
- Keep the device and its stylus out of the reach of children to avoid injury.
- If the device is not going to be used for long periods of time, insert it into the cradle for continuous power supply.
- Do not place any heavy object on the device.
- Do not use the device in humid or dusty places or near heat sources (heaters, cigarette light).
- Before resetting the device, please backup programs and data in advance.
- Before proceeding with software reset, please backup currently-using programs and data to external storage devices such as a USB drive.
- Be careful neither to drop the device nor to give it an excessive shock.
- If the touch screen gets dirty with foreign materials, clean it before use.
- When using the touch screen, do not use sharp objects (pens, steel wires, and screwdrivers), and only use the stylus and dedicated accessories coming with the device.
- Catchwell shall not be responsible for the damages resulting from other software installed by a user after purchasing the device.

■ Laser scanner

- If the device has features like laser pointer or flash, do not level them at the eyes of people or animals. If doing so, their sight may be impaired.

■ Communication

- Do not use the device or make a call while driving a car to avoid an accident.
- Do not touch the device or its power plug with wet hands or you may get shocked by electricity. Turn off the device in aircraft or in hospital. The electromagnetic waves of the device may interfere with electric aviation devices or medical equipments.
- Turn off the device in the areas exposed to the risk of explosion. Especially, it is safer to power off the device while gassing up a car.
- Be wary of using a headset (earphones). The use of headphones at high volume for prolonged periods of time may impair hearing ability.

Table of Contents

Device Notices

Information on this Manual

Manual revision history	2
-------------------------------	---

Safety Information

Power usage	3
Battery	3
Usage and storage	3
Laser scanner	4
Communication	4

1. Getting Started

Unboxing	7
Accessories	8
Device overview	9
Front and Side View	9
Rear, Top, and Bottom View	10
Device startup	11
Inserting/Removing the microSD card	11
Inserting/Removing the SIM card	12
Installing/Removing the battery	12
Charging the battery	13
Turning on the power	14
Turning off the power	14
Connection	15
USB to PC	15
ActiveSync (Windows Mobile Device Center)	15
Wireless Manager	16
Installing the hand strap	17
Using the stylus	18

2. Operating the Device

Touch screen actions	19
Home screen	19
Change the home screen layout	20
Title bar information	21
Connection status indicators	21
Call and signal strength indicators	21
Sound status indicators	22
Battery level indicators	22
Task bar information	23
Text input	24
Function buttons	25
Alphabet/Numeric Indicator	25
Customizing hardware buttons	26
Setting the HotKey	26
Setting the KeyMap	27
Creating a simple keymap	27
Setting the keymap	29
Adjusting volume	30
LED Indicator	30
Resetting the device	31
Soft reset	31
Hard reset	31
Locking or unlocking the screen	32

3. Customizing the Device

Checking device information	33
Customizing quick launcher utilities	33
Customizing startup utilities	34
Setting barcode	35
Setting the power button	35
Setting External I/O	36
Viewing dashboard information	37
Setting modem band	38
Setting screen ratio	38

4. Using Bluetooth

Using Microsoft Bluetooth	39
Turning on or off the Bluetooth mode	39
Pairing Bluetooth devices	40
Available services	41

5. Data Collection

Scanning considerations	42
Range.....	42
Angle.....	42
Laser scanning.....	42
Scanning barcodes	42
Image decoding.....	43
Operation modes.....	43
Image scanning.....	44
Taking a picture.....	45
Video recording.....	46
Viewing pictures and videos	48

6. Calling & Messaging

Setting a SIM card	49
Setting the phone	49
Making a call	50
Answering a call.....	51
Ending a call	51
Managing contacts.....	52
Adding a contact	52
Edit a contact	52
Deleting a contact.....	53
Smart dialing	53
Speed dialing	54
Adding to speed dial	54
Editing speed dial.....	55
Deleting speed dial.....	55
Call history	55
Emergency call	55
Messaging.....	56
Sending a message.....	56
Replying to a message.....	56

7. Using WLAN

Turning on WLAN	57
Turning off WLAN	57
Setting AP connection with SCU(Summit Connection Utility).....	58
Setting up AP connection with WZC(Wireless Zero Configuration)	62

8. GPS Navigation

GPS Navigation	64
----------------------	----

9. Maintenance and Troubleshooting

Maintaining the device	65
Cleaning.....	66
Cleaning the device.....	66
Cleaning cradle connectors.....	66
Troubleshooting	67
General.....	67
Connection	68

10. Specifications

Specifications.....	69
---------------------	----

11. Regulatory Compliance Information

European Conformity Statement	70
Battery Information	70
RoHS Statement.....	70
Laser Safety Statement.....	70

12. Customer support

Customer support.....	71
-----------------------	----

Index

Index	72
-------------	----

1. Getting Started

This chapter describes the basic information you need before using the device, such as installation, battery charging, etc.

■ Unboxing

Please check if there is any damaged or missing component in the box. If there is any problem, contact the supplier.



The illustrations shown above may differ from the actual device.

■ Accessories

- 1-slot cradle components

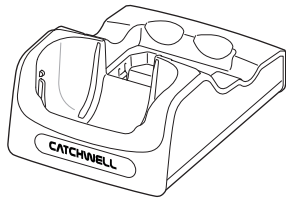

Cradle

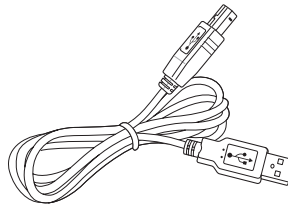

USB cable

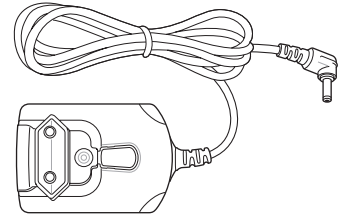

Adaptor

- 4-slot cradle components

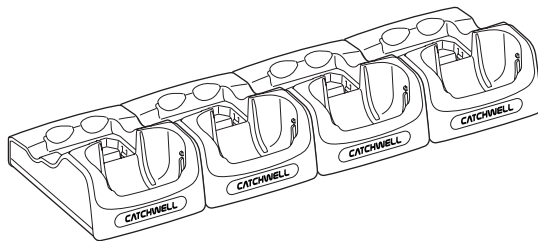

4-slot cradle

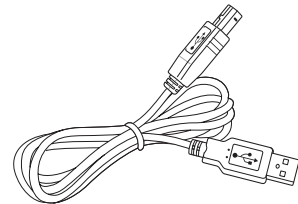

USB cable

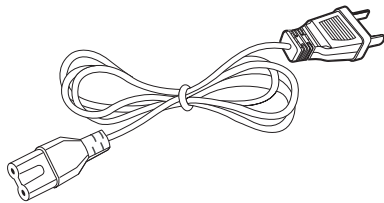

Power cord

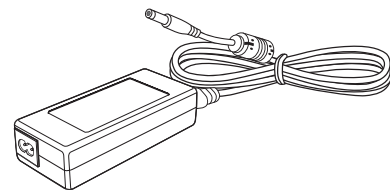

Power adaptor

- Snap on I/O components (For external communication)

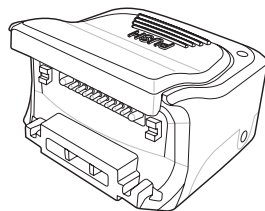

Snap on I/O

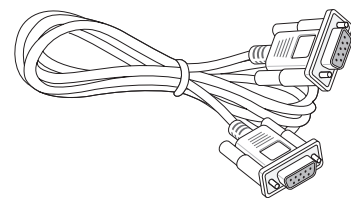

RS232 cable

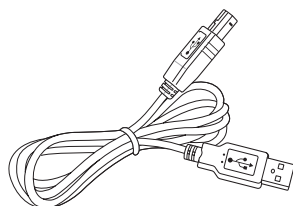

USB cable

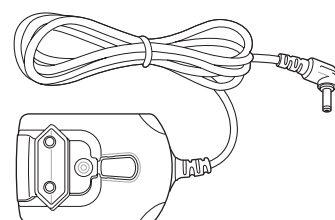

Adaptor

Device overview

Front and Side View

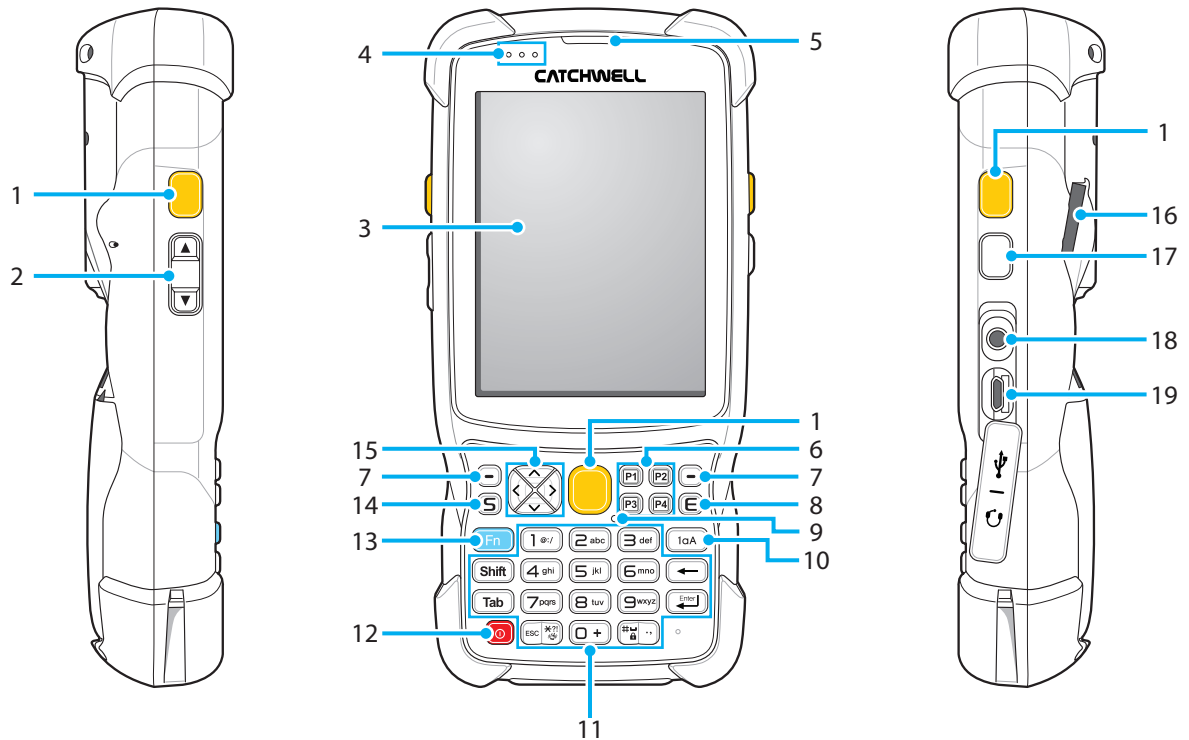

No.	Name	No.	Name
1	Scan button	11	Numeric and alphabet button
2	Volume button	12	Power button
3	Touch screen	13	Function button
4	Status LED indicator	14	Send button
5	Receiver	15	Direction button
6	Hotkey	16	Stylus holder
7	Soft key	17	Programmable button (This button can be programmed by SDK.)
8	End button		
9	Reset button	18	Headset jack
10	Keymap button	19	USB port

Rear, Top, and Bottom View

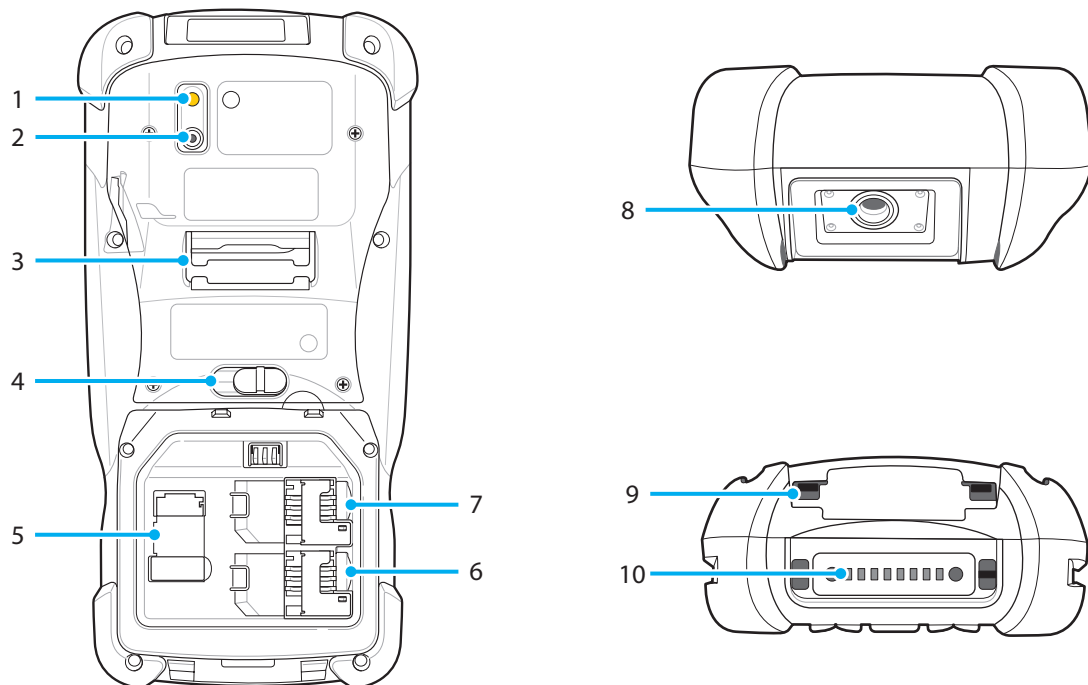

No.	Name
1	Camera flash
2	Digital camera
3	Hand strap mount (top)
4	Battery release latch
5	microSD card slot
6	SIM card slot 2 (SAM option available)
7	SIM card slot 1 (Default)
8	Scanner
9	Hand strap mount (bottom)
10	Connector



The scanner shape may vary depending on the model.

■ Device startup

Before using the device, read the following information carefully.

Inserting/Removing the microSD card

The microSD card provides secondary non-volatile storage. The microSD™ card holder is located under the battery. Before inserting the microSD™ card, make sure to turn off your device and remove the battery.

- 1 Slide the battery release latch to the unlock position, and remove the battery.
- 2 Insert your fingernail into the slot and lift the rubber cover from the compartment.
- 3 Place the microSD™ card with the contact surface facing down, and push it into the slot until it locks into the place.

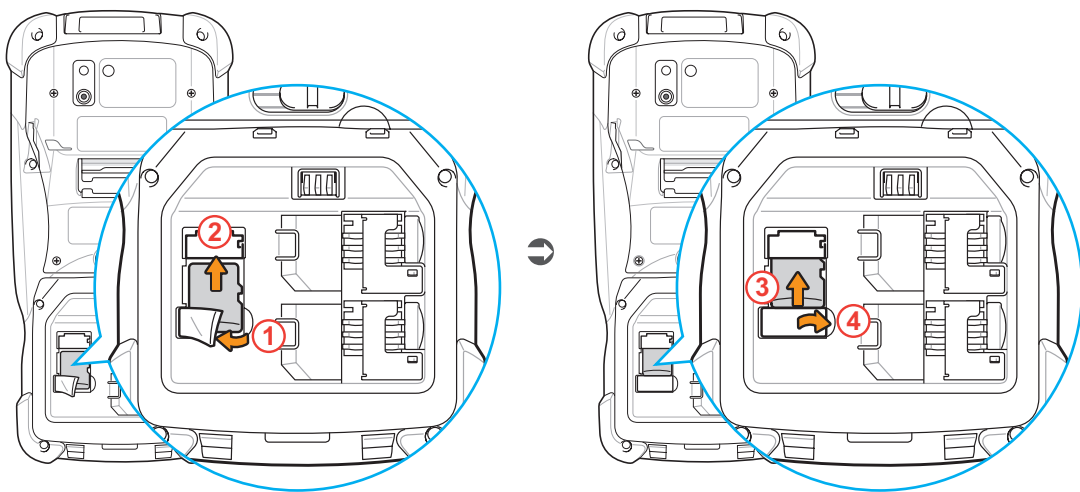

- 4 To remove the microSD™ card from the device, hold the microSD™ card carefully and slide it out from the slot.



Caution

To prevent the microSD™ card from damages, be careful about static electricity. It is recommended to follow proper Electro-Static Discharge (ESD) precautions to avoid damaging the microSD™ card.

Inserting/Removing the SIM card

Please refer to the manual provided by your service provider for the further information about using the SIM card. Before inserting the SIM card, make sure to turn off your device and remove the battery.

- 1 Slide the battery release latch to the unlock position, and remove the battery.
- 2 Place the SIM card into the SIM1 slot (Default). Make sure the gold contacts of the card go against the metal contacts of the device.

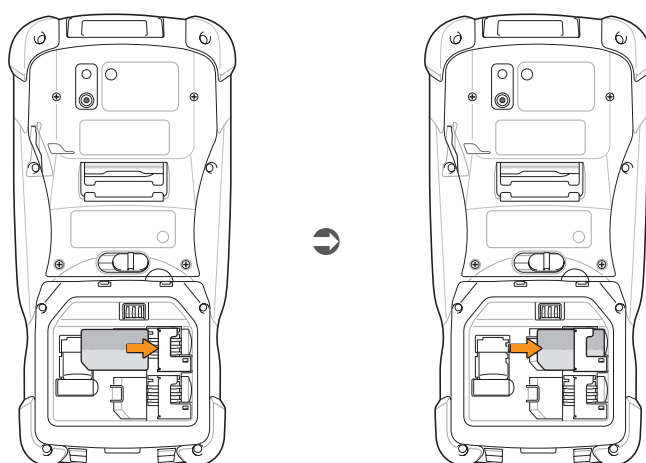

- 3 To remove the SIM card from the device, hold the SIM card carefully and slide it out from the slot.



You can select the desired SIM card by tapping  > **Settings** > **System** > **SIM Selector**.

Installing/Removing the battery

- 1 Align the battery contacts with the terminals in the battery compartment.
- 2 Press down the battery firmly.
- 3 Slide the battery release latch to the lock position.

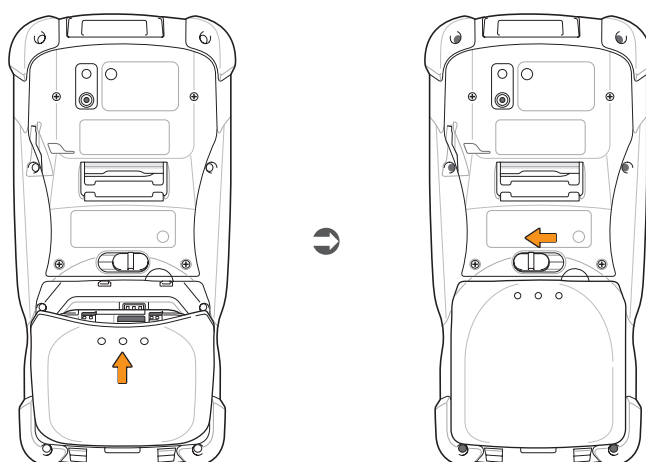

- 4 To remove the battery, slide the battery release latch to the unlock position and then remove the battery.

Charging the battery

The single slot cradle can charge both the device main battery and a spare battery simultaneously.

To charge the device:

- 1 Connect the power cable to the cradle's power jack.
- 2 Insert the power plug into the wall outlet.
- 3 Place the device into the cradle.
A red LED at the front of the device lights if the device is correctly docked.
- 4 When charging is complete, remove the device from the cradle.

To charge a spare battery:

- 1 Insert the spare battery into the spare battery charging slot, bottom first, and pivot the top of the battery down onto the contact pins.
- 2 Gently press down on the battery to ensure proper contact.
- 3 When charging is complete, press the battery clip and lift the battery out of the slot.

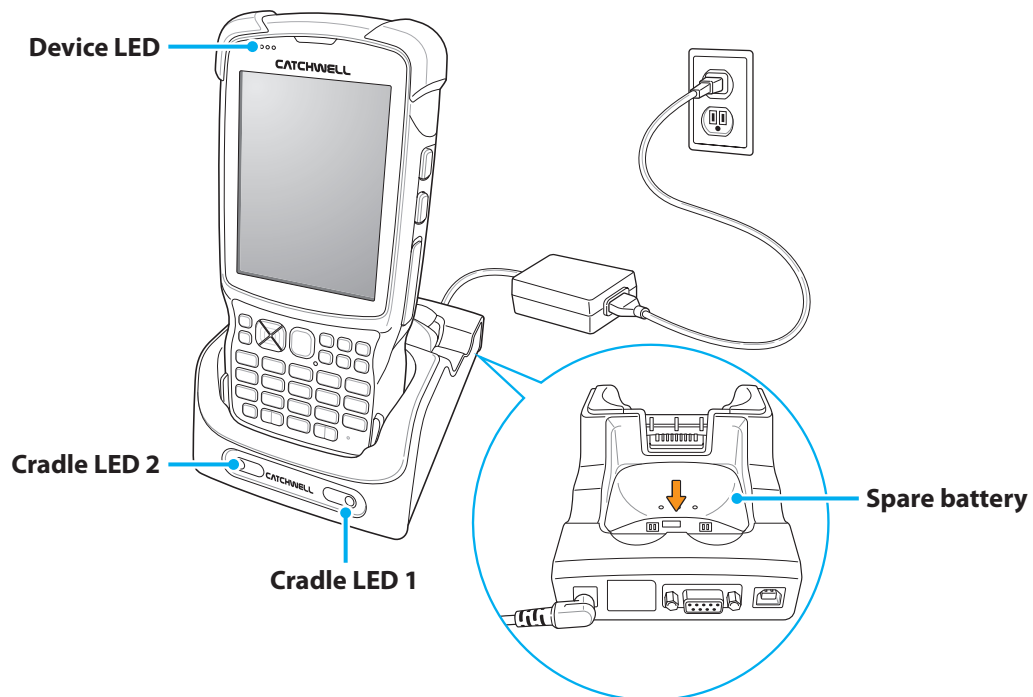

Indicator	Display	Description
Device LED	Red	Battery is charging.
	Green	Battery is fully charged.
	Red blinking	Error in charging.
Cradle LED 1	Red	A spare battery is charging.
	Green	A spare battery is fully charged.
	Red blinking	An error happens in charging.
Cradle LED 2	Green	The device is connected to PC via a USB cable.

Turning on the power

- 1 Press and hold the power button until the device starts vibrating.

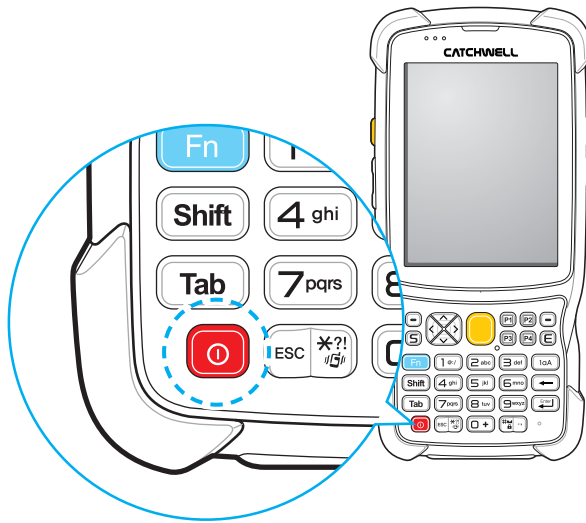

- 2 Catchwell logo appears.

When you press the power button again, the device turns to the Suspend mode. You can set the power button action that will be done after being pressed for your convenience. Refer to page 35 for details on the power button setting.



- The screen may differ depending on devices.
- If the device does not start after pressing the power button, check if the battery is fully charged. If the battery is charged, perform hardware reset (cold booting). For more information, refer to **Resetting the device** on page 31.
- If the device will not be used for a long time, remove the battery. Please use a fully charged battery when turning the device back on.

Turning off the power

- 1 Tap  > **Power Options** > **Power Off**.

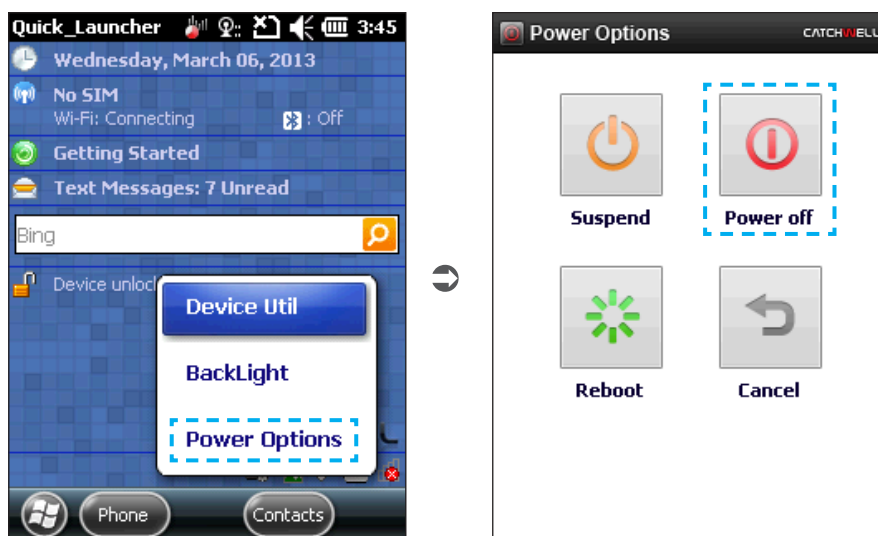

■ Connection

The connection manager provides access to the device's various communication options.

USB to PC

The USB to PC enables you to switch between RNDIS(Remote Network Driver Interface Specification) USB and serial USB communication.

- 1 Tap  > **Settings** > **Connections** > **USB to PC**.
The checkbox is checked by default. If the option is not selected, it indicates that you are in serial USB mode.

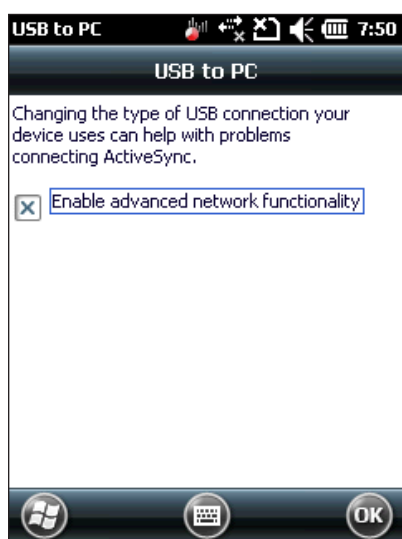

- 2 To switch to RNDIS USB mode, tap the **Enable advanced network functionality**.
- 3 Tap **OK**.

ActiveSync (Windows Mobile Device Center)

Through the ActiveSync program, the data can be transferred between the device and PC.

* What is ActiveSync?

ActiveSync® is a communication program between PC and the device developed by Microsoft®, and it allows file transfer, deletion, content synchronization/modification, and other features.

If any other device is connected to your PC before installation, please remove them before installation process.

Visit Microsoft® website (<http://www.microsoft.com/downloads>) to install ActiveSync program on your PC.

It is recommended to install the latest version. If the PC has Microsoft® Windows Vista or the later version of Windows, instead of ActiveSync®, install Windows Mobile device Center® (<http://www.microsoft.com/windowsmobile/ko-kr/help/v6-5/Windows-Mobile-device-Center-touch.aspx>).



Use a cradle or a USB cradle for connection between the device and PC.

Wireless Manager

You can manage the connection of the wireless applications installed in the device.

- 1 Tap  > **Settings** > **Connections** > **Wireless Manager**.



- 2 To turn on or off the function, select the corresponding function name.
- 3 To configure connections settings, tap **Menu** and the settings of each application.

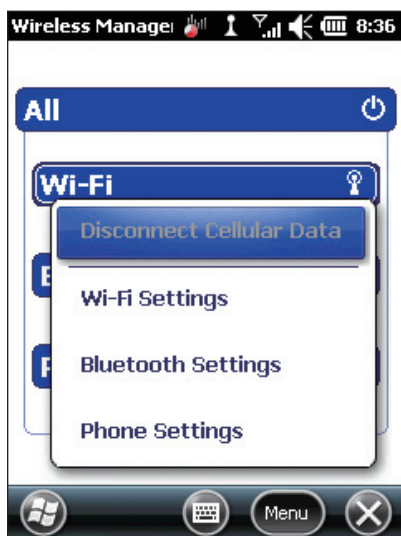

■ Installing the hand strap

Adjust the hand strap for the convenient use of the device.

- 1 Connect the hand strap to the bottom mount.

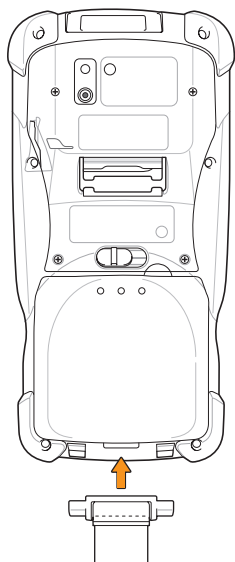

- 2 Adjust the length of the hand strap by passing the velcro through the hole.

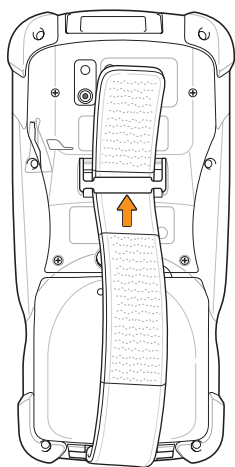

- 3 Press both sides of the strap together to get fixed.

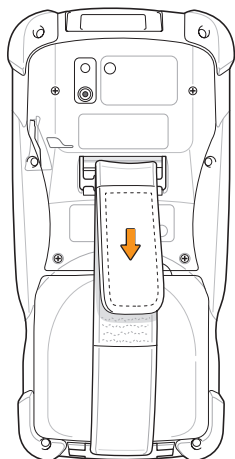

■ Using the stylus

Use the stylus to select the desired items or enter information into the screen. The stylus functions as a pen and a mouse. Tap the screen once with the stylus to select options or open menus.

Slide the stylus into the stylus holder when not using it.

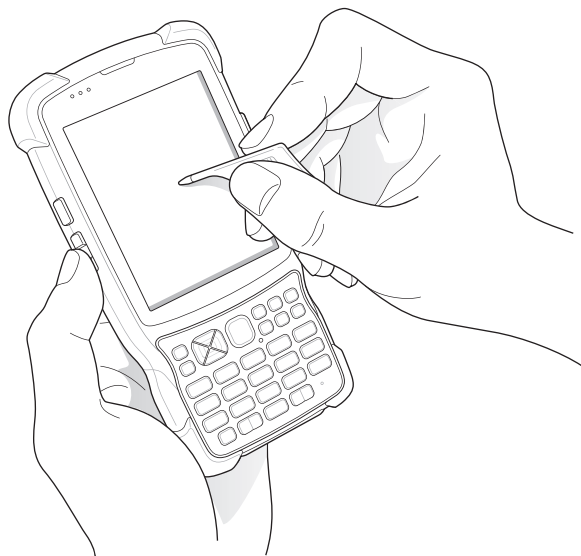

2. Operating the Device

This chapter provides basic instructions for using the device and navigating its softwares.

■ Touch screen actions

Run an application or perform functions using the touch screen. The following finger actions help you easily understand how to use the touch screen.

Tap the app or element.

Open an app or other screen element

Tap and hold to open a menu with further options

Place a finger on an item until the menu opens.

Tap and hold to drag an item

Place a finger on the item for a second or two, and slide a finger across the screen.

Swipe

Place a finger on the screen, and steadily slide a finger in the desired direction.

■ Home screen

The home screen shows the information status.

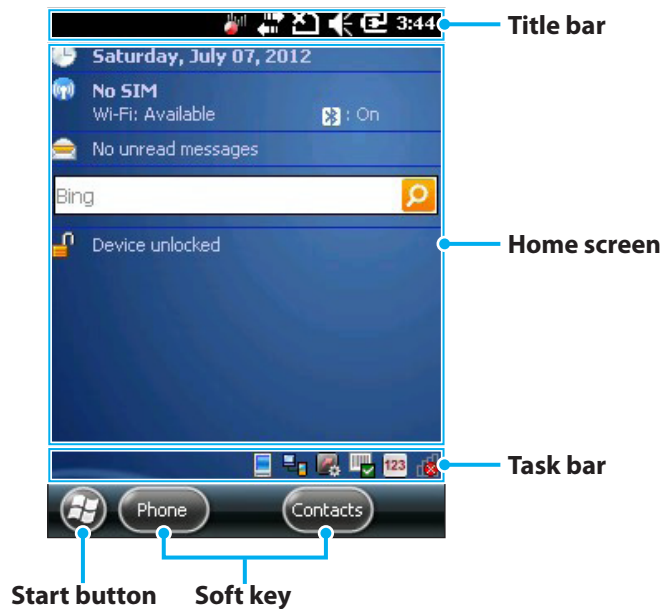

Change the home screen layout

- 1 Tap  > **Settings** > **Home**.
- 2 Select and tap **Items** in the upper tab.



- 3 Uncheck the checkbox that was pre-checked and select other options.
- 4 Tap **OK**.



- Task bar is only available in the classic layout.
- When selecting **Tasks** and **Calendar**, you can also set the options.

Title bar information

The title bar at the top of the screen shows you connection, call, signal strength, etc.











Connection status indicators



Icon	Description
	A USB is connected.
	A USB is not connected.
	Synchronization in progress
	A Wi-Fi is available.
	A Wi-Fi is in use.
	HSDPA is available.
	3G is available.
	GPRS is available.
	EGPRS is available.

Call and signal strength indicators







Icon	Description
	There are missed calls.
	Dialing without SIM card
	Call is in progress.
	Calls are forwarded.
	Call is on hold.
	Connected to a wireless network with strong signal strength.
	Not connected to a wireless network.
	No service or signal search is not available.

Icon	Description
	Connecting to HSDPA
	HSDPA is in use.
	Connecting to 3G.
	3G is in use.
	Connecting to GPRS.
	GPRS is in use.
	Roaming in progress
	No SIM card installed.

Sound status indicators

Icon	Description
	Sound is on.
	Sound is off.
	Vibration mode is on.

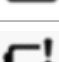
Battery level indicators

Icon	Description
	Main battery is being charged.
	Main battery is fully charged.
	Main battery is charged enough.
	Main battery is half charged.
	Main battery is low.
	Main battery is very low.

■ Task bar information

The Task bar shows you SCU signal strength, barcode setting, keypad setting, etc. Pressing the indicators of SCU signal strength, barcode setting, and Quick launcher, you can select the corresponding setting option items.

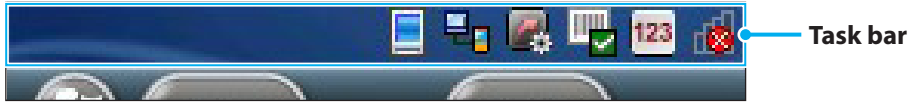

Icon	Description
	Displays wireless signal strength. The greater the number of bars, the stronger the signal.
	No WLAN signal
	Decode Only Mode/ Decode Mode is set to be enabled. You can decode 1D/2D barcodes.
	Even though the Message Mode is set to be enabled, the program does not work.
	Decode Mode is set to be disabled.
	Scanning in progress
	Image Only Mode is set to be enabled. You can scan and display a photograph barcode(2D barcode) on the screen.
	Both Decode Mode and Image Mode are to set to be enabled. You can do simultaneously barcode decoding with barcode-image filming.
	Multi Scan Mode is set to be enabled. You can decode multiple barcodes quickly and conveniently. New barcodes can be decoded while holding down the scan button.
	Numbers can be inputted.
	Korean characters can be inputted.
	English characters can be inputted.
	Customizing keys can be inputted.
	The Fn keys can be inputted.
	Single uppercase letter can be inputted.
	Caps lock key is enabled.
	A USB is connected to PC. The icon is displayed only in USB Serial Mode.
	Quick Launcher
	RFID Status

Text input

There are three ways of inputting text: Numeric, QWERTY, and virtual keypads.

The keypads default characters/functions are printed white and the function button is printed blue.

Numeric keypad

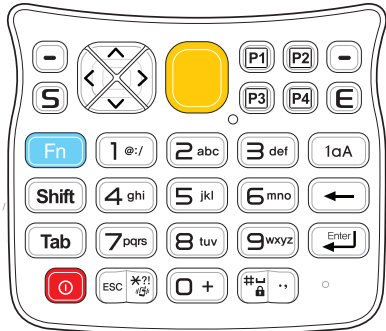

QWERTY keypad

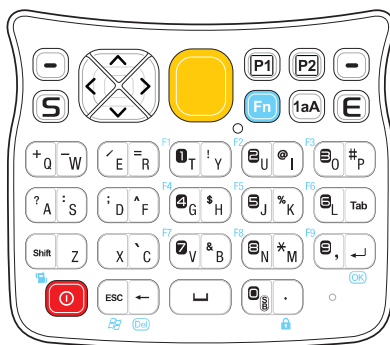







Virtual keypad

123	1	2	3	4	5	6	7	8	9	0	- =	←	
Tab	q	w	e	r	t	y	u	i	o	p	[]		
CAP	a	s	d	f	g	h	j	k	l	;	'		
Shift	z	x	c	v	b	n	m	,	.	/	↵		
Ctl	á	ü	`	\						↓	↑	←	→

Function buttons

Functions buttons appear on both keypad and perform specific functions.

Name	keypad	Function
Backspace		Moves the cursor back one space. If you are typing text, a character is deleted each time you press the backspace key.
Escape		Cancels an action.
Enter		Performs the same function as the Enter key on a PC.
Scan		Activates the image engine to scan a barcode.
Tab		Moves the cursor to the next tab stop or field.
Shift		Provides functions as a shift key and a Caps Lock key in alpha mode.
Keymap Changer		Changes the keymap.

Alphabet/Numeric Indicator

Alphabet/numeric indicator in the task tray indicates the alpha/numeric status of the keypad.

Alphabet/Numeric indicator

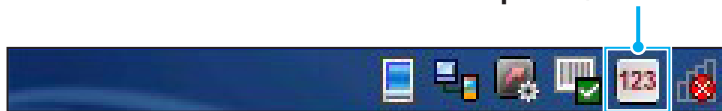

■ Customizing hardware buttons

You can set the Hot Key, KeyMap, and Keymap options.

Setting the HotKey

You can customize 9 keys (Fn1 ~ Fn9). Additionally, for the numeric keypad, you can customize 4 keys (P1 ~ P4) and for QWERTY keypad, 2 keys (P1 and P2).

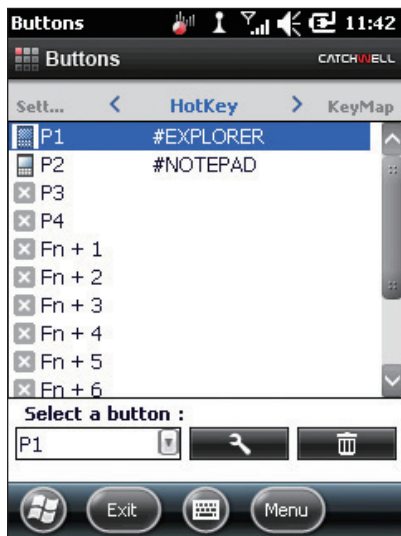

- 1 Tap  > **Device Utility** > **Buttons**.

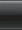

- 2 Select a button.
- 3 Tap  to save the setting.
- 4 Select a function from the **Assign a function** drop-down list.
 - **Add Program linkage:** Sets a desired program to be operated.
 - **Input Key code:** Sets a key code.
 - **Print character string:** Sets a string to be inputted automatically.
 - **PDA Specific function:** Sets a specific function of the device to be operated.
- 5 Tap **OK**.

You can modify or delete the HotKey setting by pressing the below buttons.





- : Modifies the HotKey setting.
- : Deletes the HotKey setting.

Setting the KeyMap

You can configure or customize your own keymap.



- 1 Tap  > **Device Utility** > **Buttons**.
- 2 Select **KeyMap** on the upper tab.



- 3 Check an option box to set the basic keymap.
- 4 To register your own desired keymap, tap .
- 5 To delete a registered keymap, tap .

Creating a simple keymap

You create a simple keymap.

- 1 Tap  > **Device Utility** > **Buttons**.
- 2 Select **KeyMap** in the upper tab.
- 3 Tap .

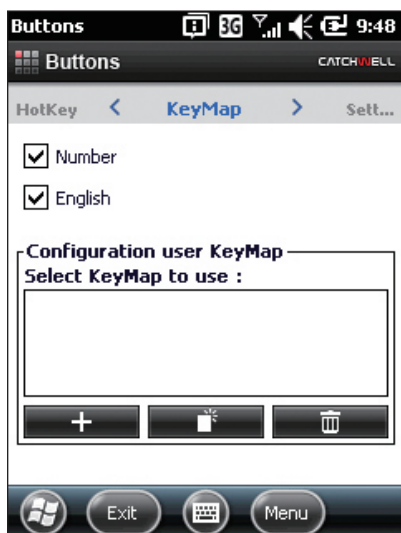

- 4 Select and tap a button on the list.

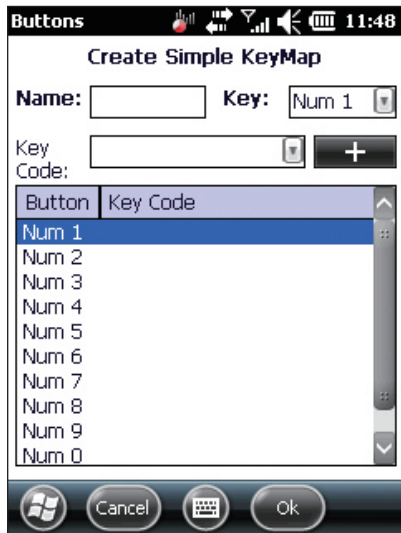

- 5 Input a name for the button.
- 6 Select and tap a key code.
- 7 Tap **+**. And then you can create more keymap.
- 8 Tap **OK** to complete the configuration.
- 9 To edit the keymap, double tap a registered keymap, and then tap **Edit**. And then edit the keymap and tap **OK**.



Setting the keymap

You can set to input a character string by tapping and holding the keypad after checking the Enable character repeat option box.

- 1 Tap  > **Device Utility** > **Buttons**.
- 2 Select **Setting** in the upper tab.

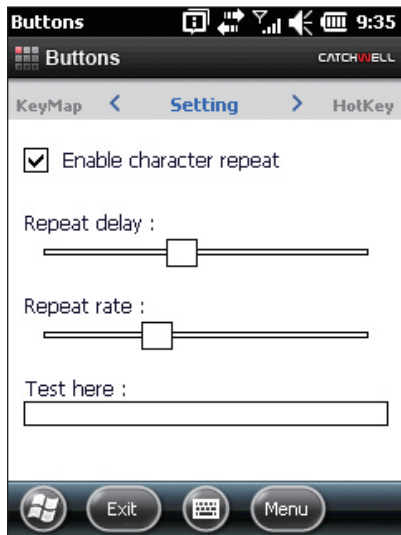

- 3 Check the option box for **Enable character repeat**.
- 4 Adjust the setting option bars.
 - **Repeat delay:** Sets the speed for a button to be inputted repeatedly. When you move the setting bar to the right, the repeat character string is inputted more slowly.
 - **Repeat rate:** Sets the rate for a button to be inputted repeatedly. When you move the setting bar to the right, the repeat rate for a character string drops.

■ Adjusting volume

You can adjust the system volume using the speaker icon in the title bar.

- 1 Tap the Title bar and . The volume setting screen appears.

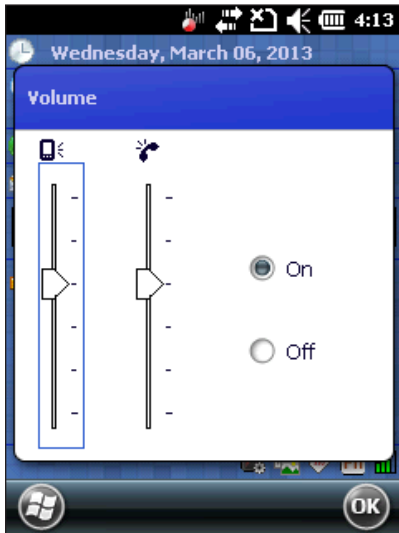

- 2 Tap and drag the slide bar to adjust the volume.
- 3 Select the **On** or **Off** to turn the volume on or off. Then tap **OK**.



You can also adjust the system volume using the volume button.

■ LED Indicator

The three LED indicates the device status.

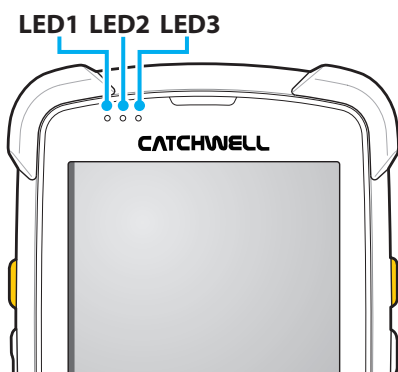

LED	Display	Description
LED1	Red	The unit is charging.
	Green	The unit is fully charged.
LED2	Green	Indicates the modem status.
LED3	Green	The unit is being booted.
	Orange	Notifies a missed call or unread SMS.
	Blinking	Notifies a low battery status.



The LED display may differ depending on device specifications.

■ Resetting the device

There are two kinds of resets: Soft reset and hard reset. A soft reset will restart the device after closing all running programs. A hard reset, also, restarts the device along with resetting the clock. The data stored in flash memory or storage card is not removed.

If the device is not working properly, perform a soft reset first. If the problem persists, perform a hard reset.

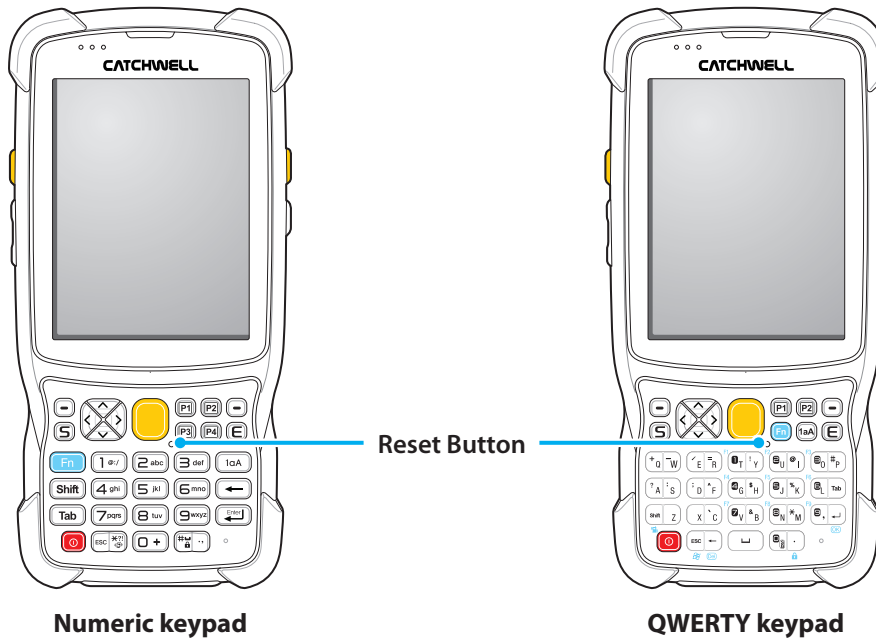

Soft reset

- 1 Press the **Reset** button with a stylus.

Hard reset

- 1 Remove the battery.
- 2 Press the **Reset** button with a stylus.



The device is automatically hard reset when you insert or remove a SIM card.

■ Locking or unlocking the screen

- 1 To lock the device, tap **Device unlocked**.
Or tap  > **Settings** > **Lock**.

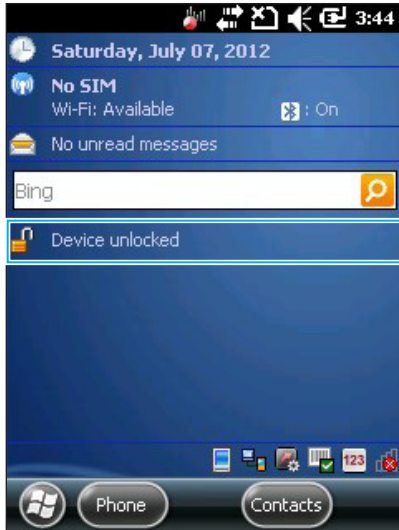

- 2 To unlock the device, slide the lock button to right or left.



3. Customizing the Device

This chapter explains how to customize the settings of the device for your convenience.

■ Checking device information

You can view the device information and reset the password.

- 1 Tap  > **Device Utility** > **Device Information**.



■ Customizing quick launcher utilities

You can set the registered programs which can be accessed using .

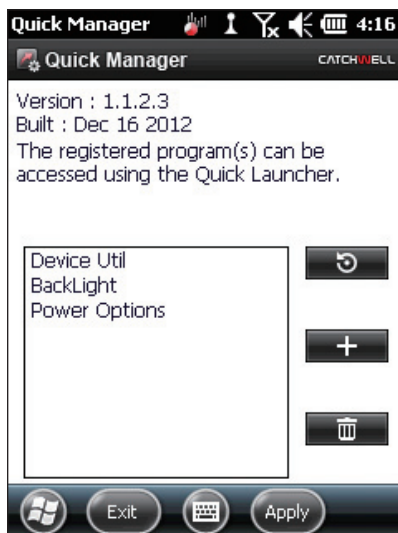

- 1 Tap  > **Device Utility** > **Quick Manager**.



- 2 Tap .
- 3 Add the program information and tap **OK**.

4 Tap **Apply** to complete the setting.

You can modify quick launcher utilities by using the screen buttons below.

- : Initializes the Quick Launcher.
- : Deletes a quick launcher utilities.

■ Customizing startup utilities

You can add startup utilities that will be automatically executed when the device is turned on.

1 Tap **Start icon > Device Utility > Startup Manager**.

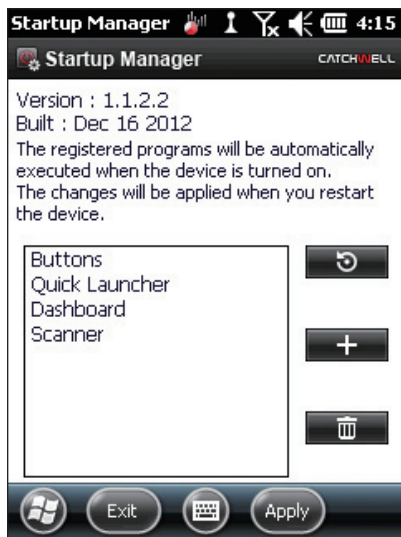



2 Tap .

3 Add the program information.

4 Tap **Apply**.

You can modify startup utilities by using the screen buttons below.

- : Initializes the Startup Manager.
- : Deletes a startup program.

■ Setting barcode

You can customize the barcode setting.

- 1 Tap  > **Device Utility** > **Barcode Setting**.

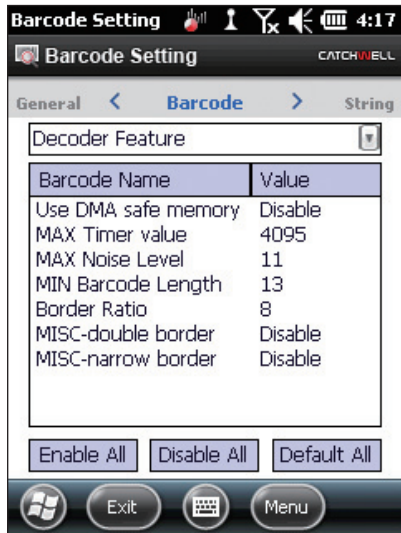

- 2 Set to enable or disable setting options.

■ Setting the power button

You can set the power button action that will be done after being pressed for power control.

- 1 Tap  > **Device Utility** > **Power Button Setting**.
- 2 Select and tap a power button setting option.

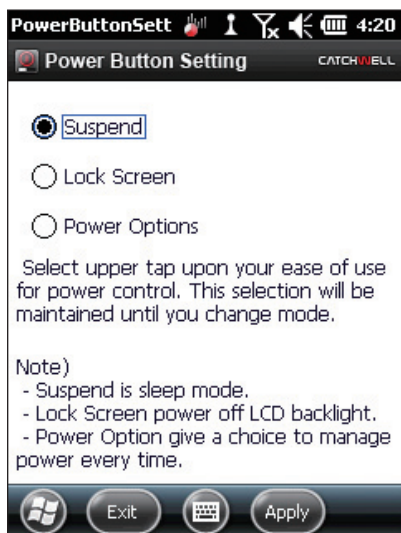

- **Suspend:** Turns off the device to activate the power save mode. The screen is turned on after the power button is pressed. Suspend is selected by default.
- **Lock Screen:** Locks the screen after the power button is pressed. When you press the power button again, you can unlock the screen. Then, the backlights are turned off, however the applications, and the connections of modem, WiFi, and BT remain active.

- **Power Options:** Sets the power button action that will be done every time the power button is pressed. When you select Power Options setting, the screen is displayed as below each time the power button is pressed. If you do not select any power option until the progress bar reaches the end, the device automatically moves to the Suspend mode.

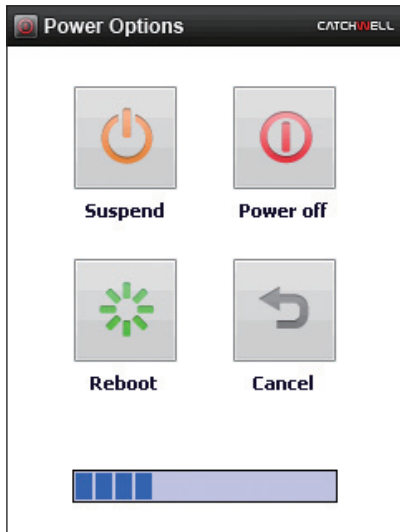

Button	Description
Suspend	Turns off the device to activate the power save mode.
Power off	Turns off the device.
Reboot	Reboots the device.
Cancel	Returns to the previous screen.

3 Tap **Apply** > **Yes**.



You can also move to the Power options screen by tapping  > **Power options**.

■ Setting External I/O

You can set to active or deactivate an external device connection.

- 1 Tap **Settings** > **System** > **External I/O**.
- 2 Select an option to enable the connection.

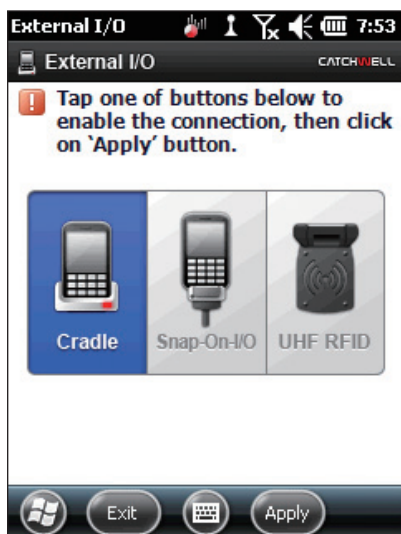

- **Cradle:** Enables to connect Ethernet, RS232, or USB. Cradle is selected by default.
- **Snap-On-I/O:** Enables to connect an external device, a serial port, or a USB without cradle.

- **UHF RFID:** Enables to connect an RFID device. When you select Cradle or Snap On I/O, you cannot select this connection option.

3. Tap **Apply**.

■ Viewing dashboard information

You can check the device information including battery status, memory storage, and the statuses of GPS, Wireless LAN, and Bluetooth.

1 Tap **Settings > System > Dashboard**.

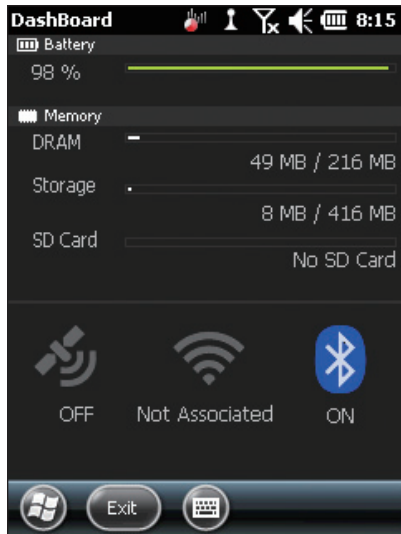

Or drag down the title bar and tap the Dashboard icon.

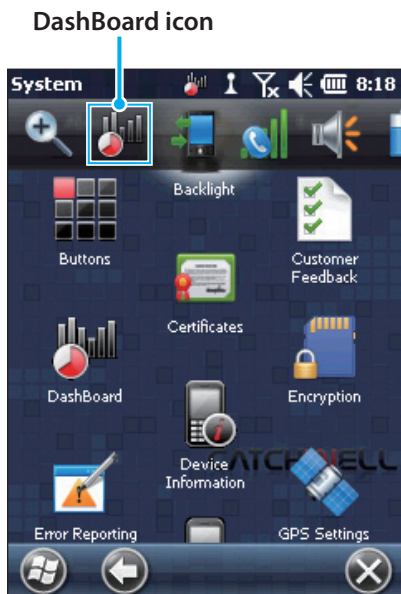

■ Setting modem band

You can set a band of the communication network depending on the modem specifications. All of the bands are selected by default. It may take long time for the device to be connected depending on network environments. Make sure to insert a valid SIM card for the setting.

- 1 Tap  > **Device Utility** > **Modem Band Setting**.

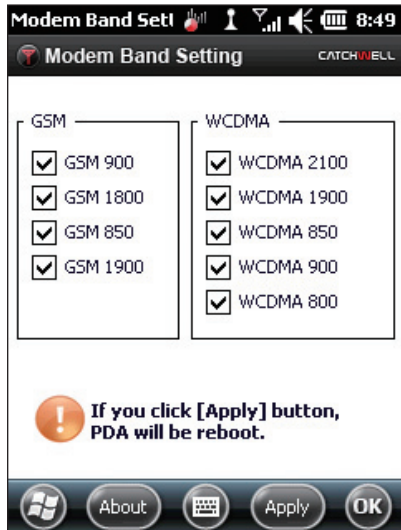

- 2 Select and uncheck the setting option box.
- 3 Tap **Apply**.

■ Setting screen ratio

You can set the screen ratio.

- 1 Tap **Settings** > **System** > **Rotation**.
- 2 Tap the touch button to enable or disable the rotation.
- 3 Tap **Apply**.

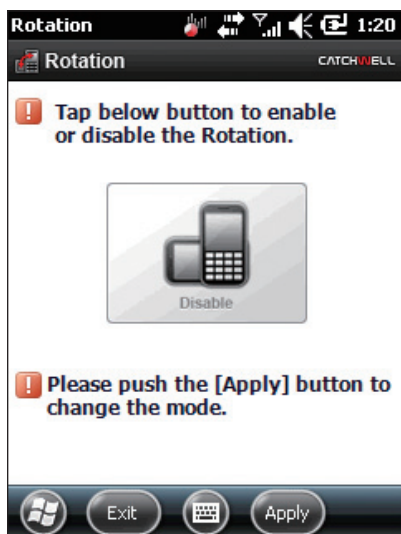

4. Using Bluetooth

A device equipped with Bluetooth technology can send and receive data within the frequency range (802.15.1) of 2.4GHz ISM (Industry Scientific and Medical) by communicating wirelessly with radio frequency in FHSS (frequency hopping spread spectrum). Bluetooth wireless technology is, in particular, designed for short-range communication (10 m / 30 ft) and low-power consumption.

CW31, equipped with Bluetooth technology, is able to exchange information (e.g. files, appointments, tasks) with other Bluetooth-support devices such as phones, printers, access points, or other devices.

■ Using Microsoft Bluetooth

Turning on or off the Bluetooth mode

Turn off Bluetooth wireless connection to save battery or when you enter an area where wireless connection is restricted (e.g. aircraft). When wireless connection is turned off, no other Bluetooth devices can detect or connect to CW31. To exchange information with other Bluetooth devices within the operation range, turn on the Bluetooth wireless connection. The communication using Bluetooth wireless connection is only available within the close distance.

To enable Bluetooth:

- 1 Tap  > **Settings** > **Bluetooth**.
- 2 Select and tap **Mode** in the upper tab.
- 3 Check **Turn on Bluetooth**.



- 4 Tap **OK**.

To disable Bluetooth:

- 1 Tap  > **Settings** > **Bluetooth**.
- 2 Select and tap **Mode** in the upper tab.
- 3 Uncheck **Turn on Bluetooth**.
- 4 Tap **OK**.



Turn off wireless connection when you do not use it to conserve battery life.

Pairing Bluetooth devices

- 1 Tap  > **Settings** > **Bluetooth**.
- 2 Select and tap **Devices** in the upper tab.
- 3 Tap **Add new device**.



- 4 Select a device from the list. And then tap **Next**.

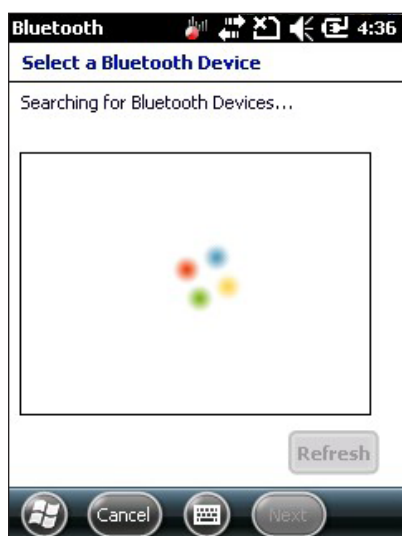

- 5 Enter a password of other device and then the device will be added to list. A message requesting a password will appear. If there is a specific password for the device, enter the password to the Password column and tap **Next**.



- If smart synchronization is pre-configured or pre-defined PIN is requested, the password input screen will not appear.
- If there is no password for the device, enter an arbitrary password and tap **Next**. Then, Bluetooth will attempt to establish a pairing with the device.
- If there is a pre-defined password, the same message will appear in the other device requesting the password. Enter the password to configure the synchronized connection (if the password of the device is entered, there is no other tasks to perform on other device).

- 6 When connected, a list of appropriate and supporting services will appear.
- 7 Select the service and tap **OK**. If you don't select the service, it will not be synchronized even if the device is synchronized. If you don't select a service, a message that keeps asking you to enter a password will appear.
- 8 The device will appear in the list of the main panel. When the both devices accept their passwords, a reliable (synchronized) pairing is established.

Available services

- Hands-Free Audio Gateway Services
- Serial Port Services
- Personal Area Networking Services
- HID Client Services
- A2DP Services

5. Data Collection

The device has an integrated laser or image scanner that collects data by scanning barcodes.

■ Scanning considerations

Scanning performance can be optimized by considering the range and the angle.

Range

- All scanning devices have their optimal recognition range (minimum or maximum distance from a barcode).
- This range varies according to barcode sizes or scanning device optics. Scanning too close or too far may decrease scanning performance.
- When scanning, move the device forward and backward in order to find an optimal operation range.

Angle

- When the laser beam reflects directly back into the scanner from the barcode, it can blind the scanner and make decoding difficult.
- Scanning at too tilted angle is more likely to fail in recognition.

■ Laser scanning

The features of CW31 are as follows:

- Recognizing various linear barcodes such as Code 39, Code 128, and 1-Dimension barcodes.

Scanning barcodes

- 1** Ensure that the device is running with a scanning application.
- 2** Aim the scan window at the barcode.
- 3** Press and hold the scan button.

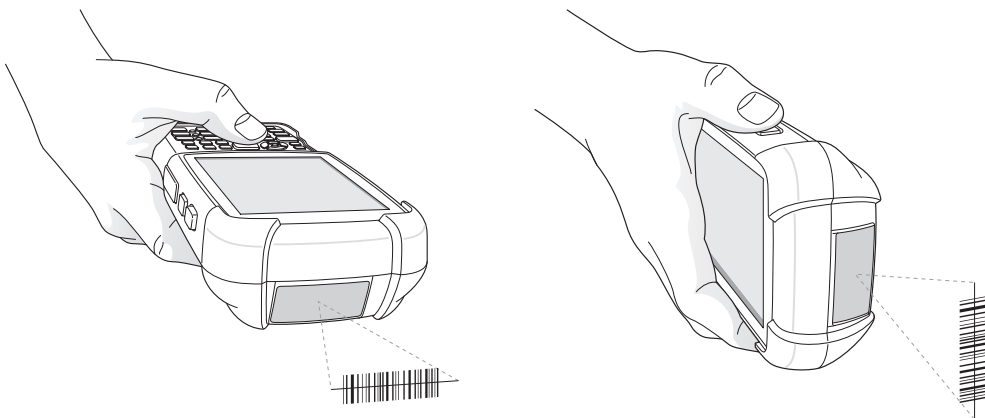

- 4 Ensure the red scan box covers the entire barcode. A beep sound indicates that the barcode was successfully decoded.



Correct



Incorrect

- 5 Release the scan button.

Image decoding

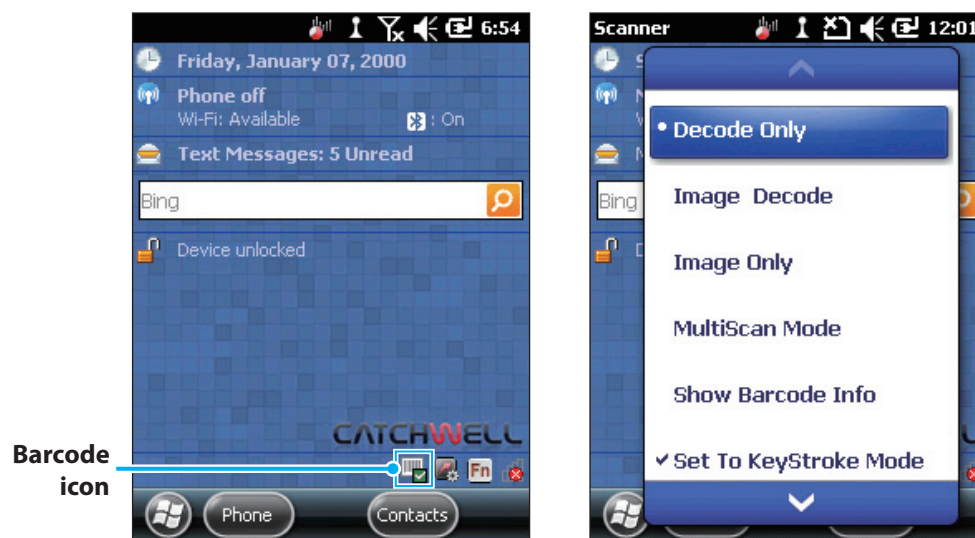

Operation modes

Image scanner supports 4 operation modes.

- **Decode Only:** Remains in decoding mode while pressing the scan button and until decoding is completed.
- **Image Decode:** Simultaneously proceeds barcode decoding with barcode-image filming.
- **Image Only:** Decodes only photograph barcodes.
- **Multiscan Mode:** Decodes multiple barcodes quickly and conveniently. New barcodes can be decoded while holding down the scan button.

Image scanning

- 1 Run a scan application if necessary.
- 2 Aim the scan window at the barcode.
- 3 Press and hold the scan button.

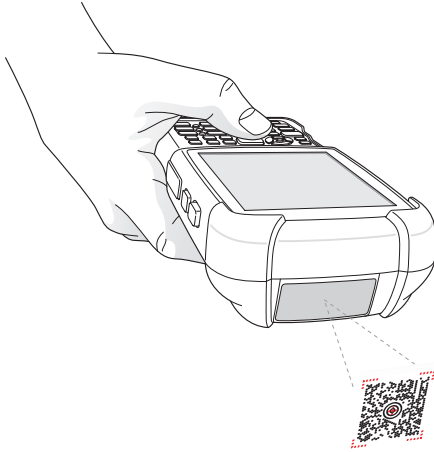

- 4 Ensure the red scan box covers the entire barcode.
A beep sound indicates that the barcode was successfully decoded.



Correct



Incorrect

- 5 Release the scan button.

■ Taking a picture

- 1 Tap  > **Pictures & Videos** > **Camera**.

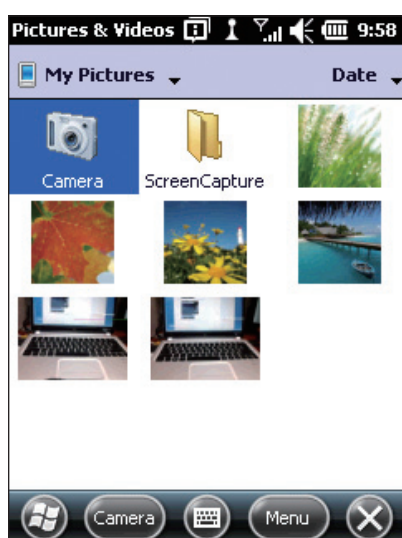

- 2 Tap **Menu** and a setting option to adjust the camera settings.

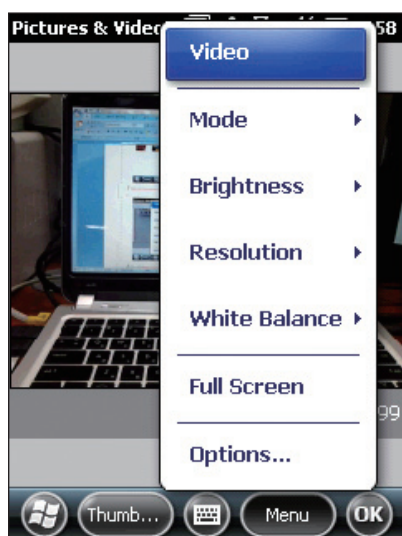

- 3 Press the Scan or Enter button to take a picture.

■ Video recording

- 1 Tap  > **Pictures & Videos** > **Camera**.

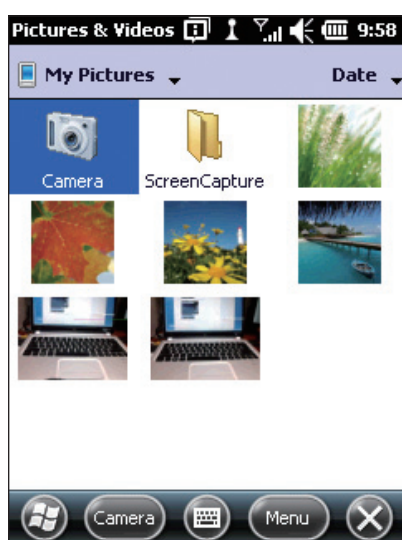

- 2 Tap **Menu** > **Video** to set the video recording mode.

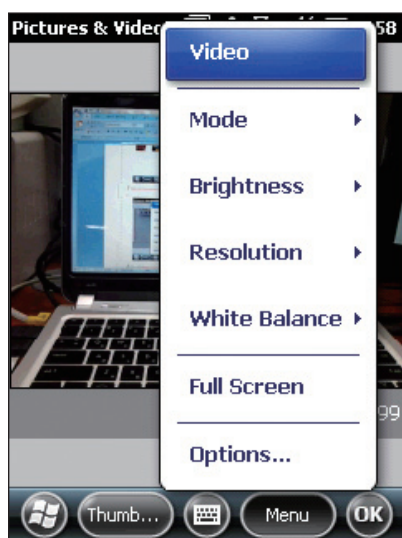

- 3 Press the Scan or Enter button to start recording a video.

- 4 Tap **Stop** to stop recording.
- 5 Tap **Pause** to pause recording. And tap **Resume** to resume recording.

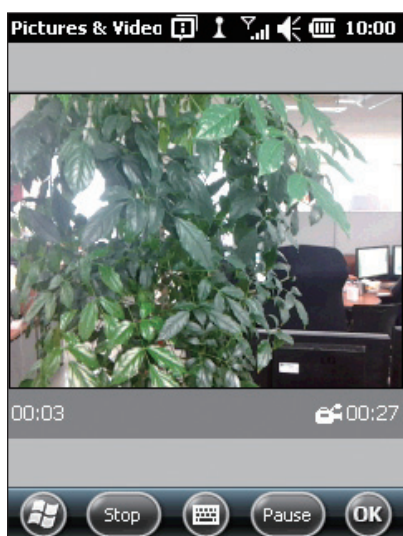

■ Viewing pictures and videos

- 1 Tap  > **Pictures & Videos.**
- 2 Select and tap a picture or a video clip you want to view.
 - **Send:** Sends the picture via message or email.
 - **Menu:** Zooms in or out, or edit a picture.
 - **Now playing:** Manages the now playing movie clip.
 - **OK:** Returns to the My Pictures folder.

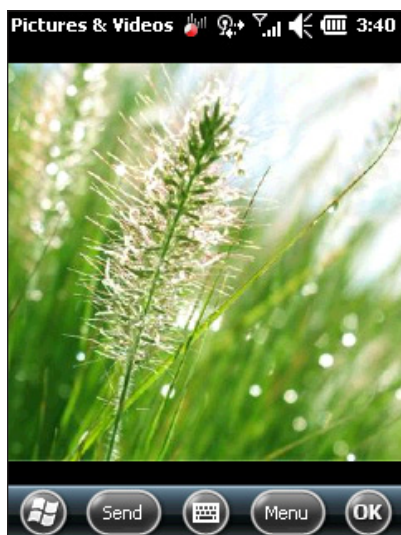

Picture viewing screen

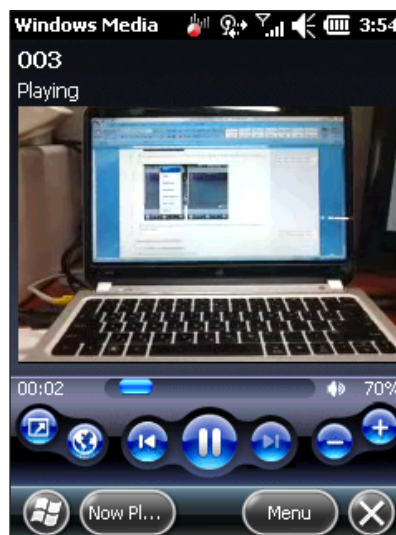

Video clip viewing screen

- 3 On the each viewing screen, you can set or edit the picture or movie clip by tapping .

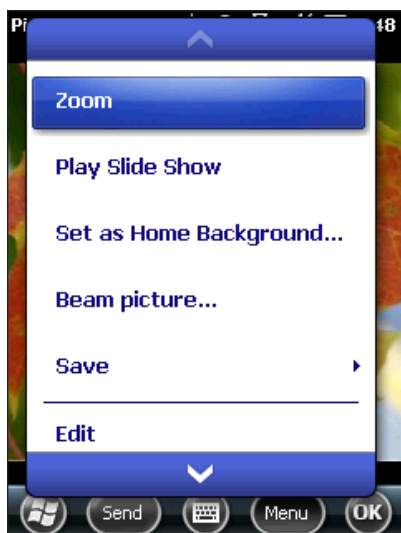

Picture menu button options

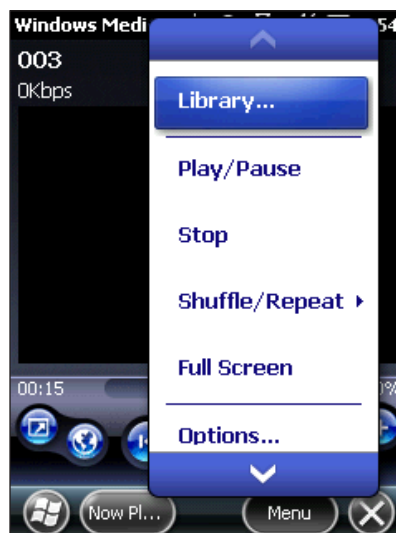

Video menu button options

6. Calling & Messaging

This chapter explains how to make a call, save contacts, send text message, etc. In addition, a user can browse the web via a dial-up network to send data in real time using various office applications.

■ Setting a SIM card

Dual SIM cards give you all the convenience of having two device in one.

- 1 Tap  > **Settings** > **System** > **SIM Selector**.

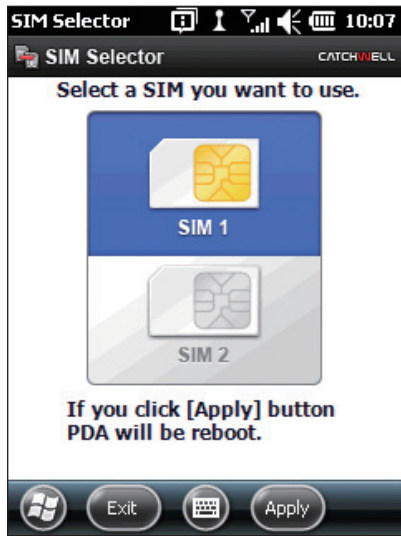

- 2 Select a SIM which you want to use. Then tap **Apply**.
- 3 A message window appears. Tap **Yes**, then the device will restart.

■ Setting the phone

The phone function can be activated or deactivated via the Wireless Manager.

- 1 Tap  > **Settings** > **Connections** > **Wireless Manager**.



- 2 Activate or deactivate by selecting **Phone**. To configure settings, tap **Menu** > **Phone Settings**.

■ Making a call

- 1 Tap **Phone**.
Or press **(S)** on the keypad.

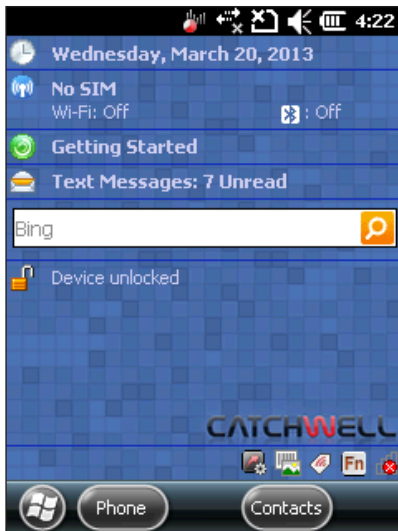

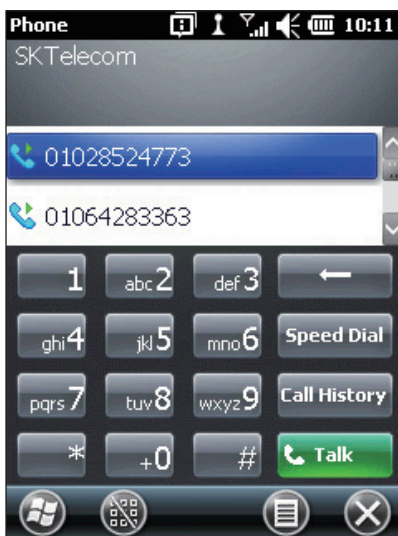

- 2 Enter the phone number.





- 3 Tap **Talk**.
Or press **(S)** on the keypad.

■ Answering a call

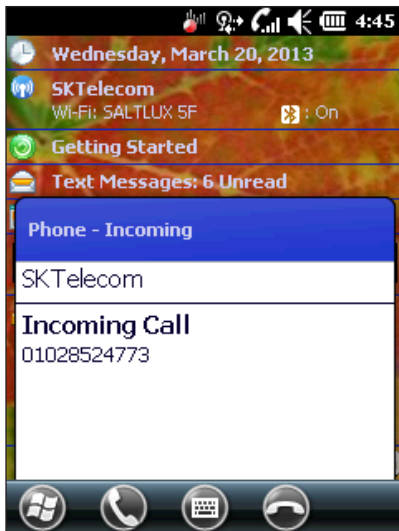
- 1 Tap  to receive an incoming call.
Or press  on the keypad.



- 2 To ignore the incoming call, tap . Then the service provider you are using will notify the caller that you are unable to answer the call.
Or press  on the keypad.

■ Ending a call

- 1 Tap **End**. Or press  on the keypad.
When the call is ended, a call summary is displayed.



■ Managing contacts

You can save names, phone number, and information to the device.

Adding a contact

- 1 Tap **Contacts**.
- 2 Tap  > **Outlook Contact**.

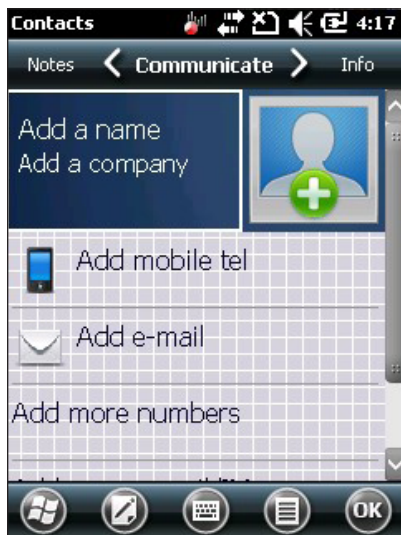

- 3 Tap the desired fields to input information.
- 4 Tap **Done** > **OK**.

Edit a contact

- 1 Tap **Contacts**.
- 2 Select and tap a contact to edit.
- 3 Tap  > **Edit**.

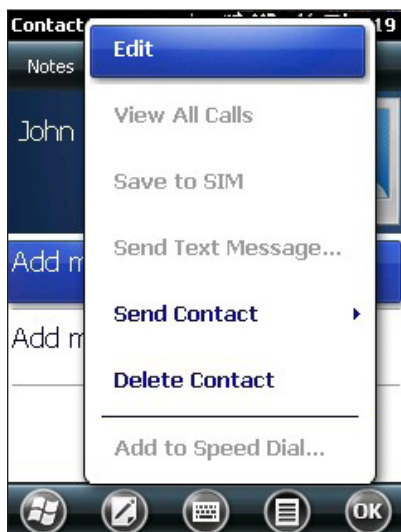

- 4 Tap and edit the desired fields to change information.
- 5 Tap **Done** > **OK**.

Deleting a contact

- 1 Tap **Contacts**.
- 2 Select and tap a contact to delete.
- 3 Tap  > **Delete Contact**.

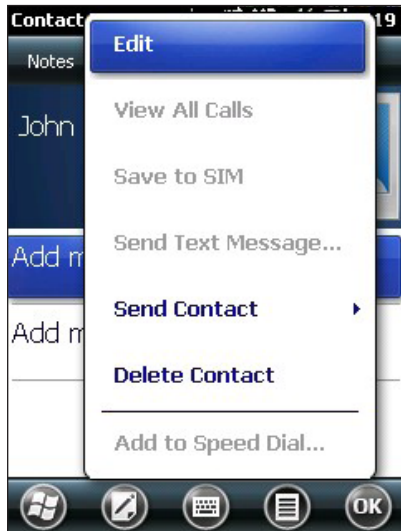

- 4 Tap **Yes**.

■ Smart dialing

When you start to enter numbers or letters, the device automatically shows you filtered list of contacts and phone number after searching for the contact items and the numbers from call history.

■ Speed dialing

You can make a call by creating a speed dial entry. After assigning a number to contacts, you can add the number to the speed dial.

Adding to speed dial

- 1 Tap **Contacts**.
- 2 Select and tap a contact.
- 3 Tap  > **Add to Speed Dial**.

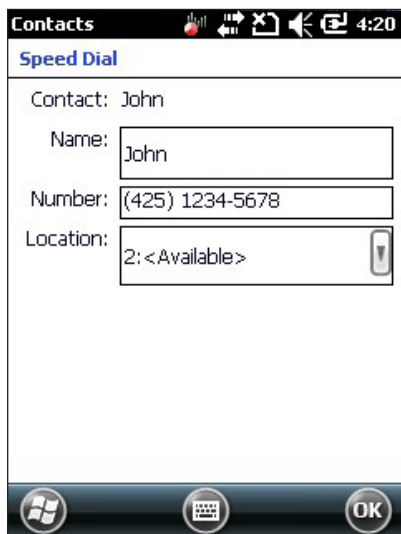

- 4 Select the location you want to assign to.

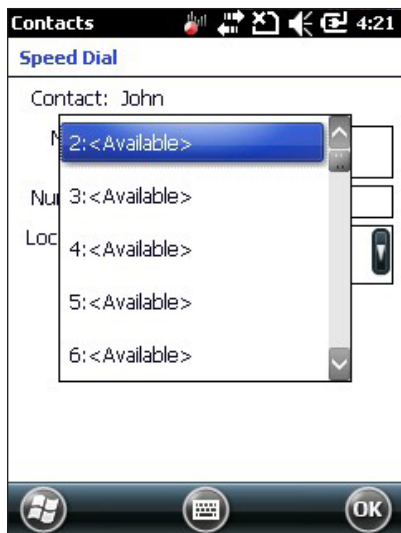



- 5 Tap **OK**.

Editing speed dial

- 1 Tap **Contacts**.
- 2 Select and tap a contact.
- 3 Tap  > **Edit Speed Dial**.
- 4 Select and tap **Location** you want to set.
- 5 Tap **OK**.



Deleting speed dial

- 1 Tap **Contacts** > Select a contact > **Menu** > **Edit Speed Dial**.
- 2 Select and tap a contact.
- 3 Tap  > **Delete Speed Dial**.
- 4 Tap .

■ Call history

You can view the call history including all, missed outgoing and incoming call logs.

- 1 Tap **Phone** > **Call History** > .

Icon	Description
	This icon is displayed next to the contact information on all incoming calls.
	This icon is displayed next to the contact information on all missed calls.
	This icon is displayed next to the contact information on all outgoing calls.

■ Emergency call

You can use a emergency call even if the SIM card is not installed. Emergency calls can be unavailable depending on network environment.



■ Messaging

You can send, receive, and save text messages.

Sending a message

- 1 Tap  > **Text** >  > **New**.







- 2 Tap **To** and then select a desired contact. If you want to know whether the receiver has received your message, tap  > **Message Options** > **Request message delivery notification**.
- 3 Enter a message into the text field.
- 4 Tap .



As the message saved at temporary message box remains there, you have to send the message manually when you are back to the service area (necessary to check the relevant features).

Replying to a message

- 1 Tap  >  > **Text**.
- 2 Select a message.
- 3 Tap  > **Reply/Forward** > **Reply**.
- 4 Enter a message into the text field.
- 5 Tap .

7. Using WLAN

This device manages communications between the device and one or more wireless terminals. This device is an IEEE 802.11 interoperable radio-equipped unit. An AP connects to a wired Ethernet LAN and acts as a bridge between the Ethernet wired network and the device. This chapter explains how to activate and to set WLAN connection.

■ Turning on WLAN

- 1 Tap  > **Settings** > **Connections** > **Wireless Manager**.
- 2 Tap **Wi-Fi** to display **Connecting**.



■ Turning off WLAN

- 1 Tap  > **Settings** > **Connections** > **Wireless Manager**.
- 2 Tap **Wi-Fi** to display **Off**.



■ Setting AP connection with SCU(Summit Connection Utility)

Summit Data Communications is a provider of industrial-grade and medical-grade wireless modules. Summit's rugged Wi-Fi devices provide secure and reliable wireless connectivity for devices such as data collection terminals and medical equipment that operate in challenging environments such as factories, warehouses, and hospitals.

You can set wireless connection through SCU. To set the wireless connection setting through SCU, you should select **Default** in SCU Active Profile Setting.

- 1 Move to the SCU setting menu by pressing  on the home screen.
- 2 Select and tap **Default** in SCU Active Profile Setting and tap **OK**.

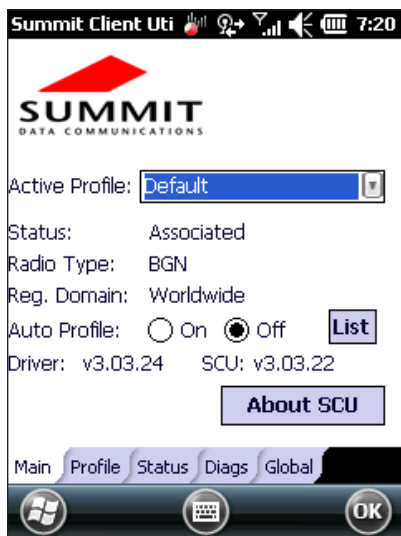

- 3 Tap  > **Settings** > **Connections** > **Wireless Manager**.
- 4 Turn off and then on the Wi-Fi function.



- 5 Tap  > **Settings** > **Connections** > **SCU**.
- 6 Select and tap the Profile tab and **Scan** to search.

- 7 Select and tap an AP and then tap **Configure**.
By tapping **Refresh**, you can refresh the searched network connection list.

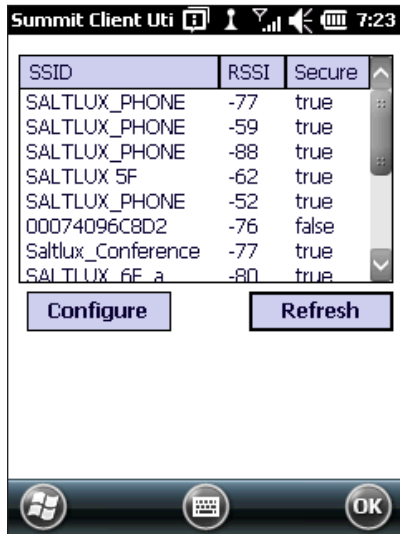

- 8 Tap **Yes** > **OK**.

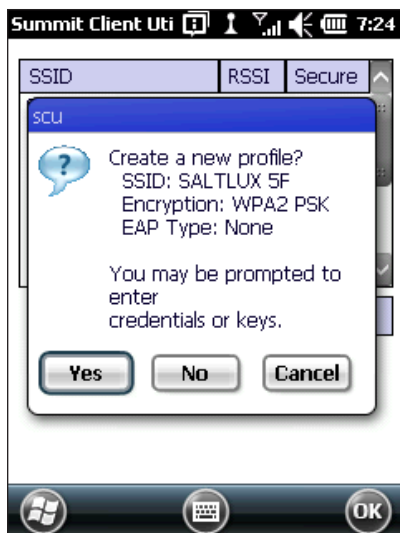

- 9 Input the AP information and tap **OK**.

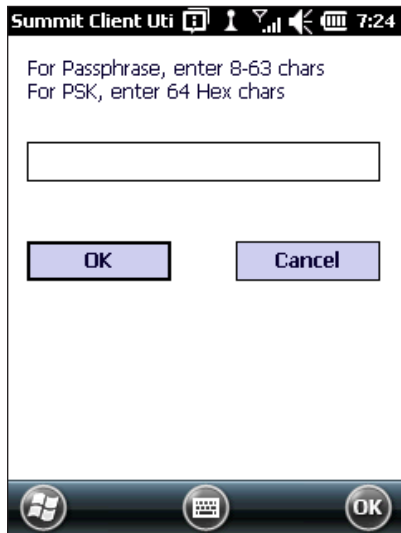

Or set security information in the **Profile** tab.

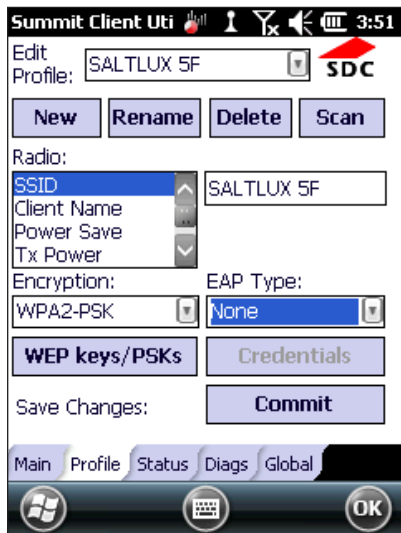

- 10 Tap **Commit** to complete the setting.
Then the AP name is saved automatically, and you can rename or delete it in the Profile tab.
- 11 Select and tap the registered profile from the Active Profile drop-down list.
Or tap **List** and select and tap the registered profile.

- 12 Set **On** for Auto Profile option setting.
Then the device is automatically connected to the AP for the registered profile.

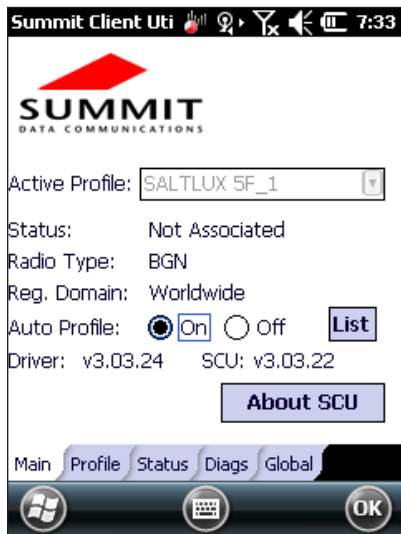

- 13 You can check the wireless signal strength in the Status tab.

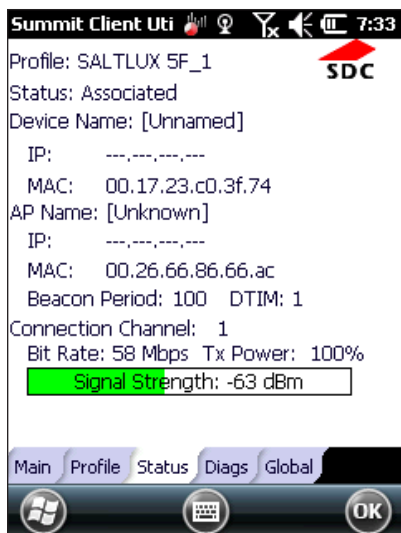

■ Setting up AP connection with WZC(Wireless Zero Configuration)

You can set wireless connection through WZC(Wireless Zero Configuration). To set the wireless connection setting through WZC, you should select **ThirdPartyConfig** in SCU Active Profile Setting.

- 1 Move to the SCU setting menu by pressing  on the home screen.
- 2 Select and tap **ThirdPartyConfig** in SCU Active Profile Setting and tap **OK**.

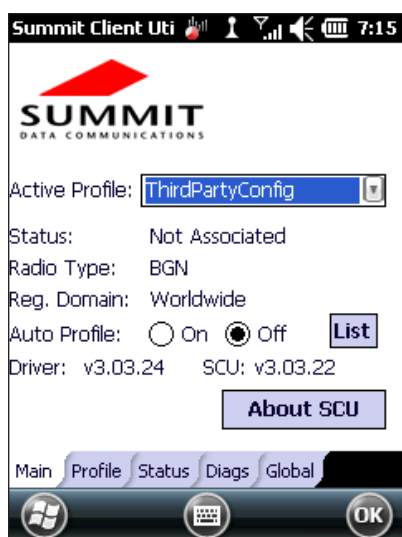

- 3 Tap  > **Settings** > **Connections** > **Wireless Manager**.
- 4 Turn off and then on the Wi-Fi function.



- 5 Tap  > **Settings** > **Connections** > **Wi-Fi**.

- 6 Select and tap a searched network.
Or tap **Add New** to configure a new wireless network.

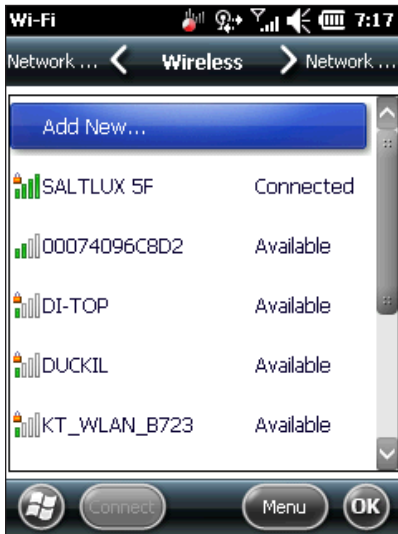

- 7 Check or configure the wireless setting options after you select and tap a searched network.
- 8 When the wireless setting options are inputted correctly, the selected network is displayed as **“Connected”**.

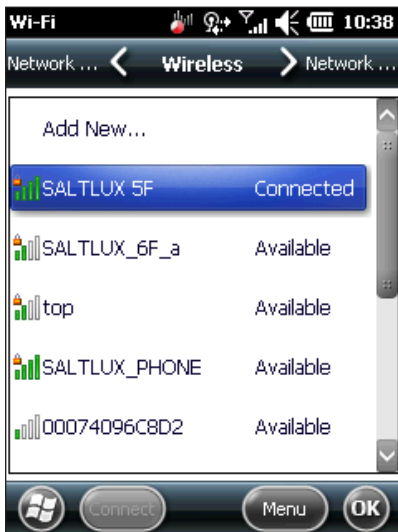

8. GPS Navigation

GPS functionality can be integrated into certain CW31. GPS technology is based on GPS satellites that transmit digital wireless signals constantly orbiting the Earth. Those wireless signals contain precise time data, and this signal is used for identifying the location of a user.

You can use the GPS function on the application downloaded on the device after setting the port to COM0 or COM4, and baud rate options to 9600 or 115200. Refer to the setting examples as below for details. BeeLine is not installed on the device and the setting screen may differ depending on GPS applications.

- 1 Tap a GPS application to open.
- 2 Go to the setting menu.
- 3 Set the port to COM0 and the baud rate to 9600.
Or set the port to COM4 and the baud rate to 115200.

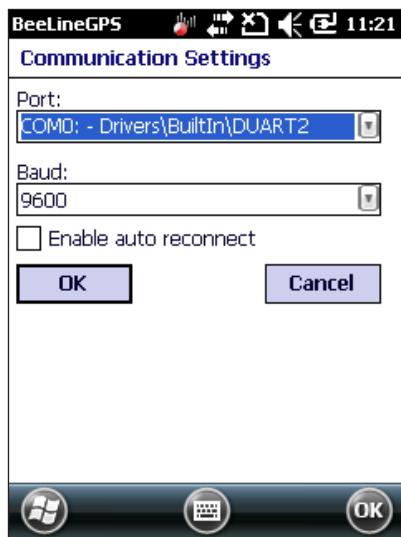

GPS application setting example

9. Maintenance and Troubleshooting

This chapter includes instructions on cleaning and storing the device, and provides troubleshooting solutions for potential problems during device operation.

■ Maintaining the device

- For trouble-free use, read following tips when using the device.
- Do not scratch the screen of the device. When working with the device, use the supplied stylus or plastic-tipped pens intended for use with a touch screen. Never use other pens or pencils or other sharp object for the screen.
- The use of protective film is recommended (a sheet of film is included in the box).
- The screen of the device is made of glass. Do not drop the device or apply excessive shock to it.
- Do not store or use the device in any location that is dusty, damp, or wet.
- Use a soft lens cloth to clean the device. If the surface of the screen gets dirty, clean it with a diluted detergent.

■ Cleaning



Avoid exposing this device to hot oil or other flammable liquids. If such exposure occurs, unplug the device and clean the device immediately.

Cleaning the device

Housing

Using an alcohol-soaked cloth, wipe the housing including keys and in-between keys.

Screen

Use only computer cleaning detergents or dedicated cleaners. Be careful not to allow liquid to pervade into the gaps at the corner of screen.

Scanner window

Clean it regularly with a lens cleaner.

Connector

- 1** Remove the battery.
- 2** Soak the end of a swap in isopropyl alcohol and rub connector pins with it.
- 3** Be careful not to leave any fluff at the surface of connectors.
- 4** Repeat this process about three times.



If isopropyl alcohol is not available, clean the connector pins with computer cleaning detergent or a pencil eraser, and be careful not to leave any foreign materials at the surface of the pins.

Cleaning cradle connectors

- 1** Remove the power cable from the cradle.
- 2** Soak the end of a swap in isopropyl alcohol and rub connector pins with it.
- 3** Be careful not to leave any fluff at the surface of connectors.
- 4** Repeat this process about three times.
- 5** Remove the foreign materials inside the cradle with compressed air.
- 6** Clean the exterior of the cradle with computer cleaning detergents.

Troubleshooting

General

Problem	Cause	Function
The device is not booted.	The battery is discharged.	Install a new battery or recharge the current battery.
	The reset button is pressed.	Remove the battery and contact the retailer where you purchased the device or manufacturer for services.
The device is frequently shut down.	The device is frequently switched to the sleep mode.	Tap  > Settings > Power > Advanced tab and change the settings.
The battery cannot be charged.	Battery damage or failure	Exchange battery and then perform hard reset.
	The charge indicator blinks and charging is not in progress.	The terminal is not properly placed in the cradle or a loose contact happens. Clean the cradle connectors and try again. If the problem persists, contact the retailer where you purchased the device or manufacturer.
The screen does not appear.	The device goes into sleep mode.	Press the power button.
	The battery is discharged.	Recharge the battery and turn on the power. Otherwise, exchange battery and try again.
The touch screen does not work properly.	Cannot tap buttons and icons.	Tap  > Settings > System > Screen > Align Screen .
"Insufficient memory to continue the execution of the program." appears.	So many application programs are running.	Close the programs that are not being used.
"Close a task window or increase the program memory." appears.	Only one program is running.	Tap  > Settings > System > Memory and delete unnecessary files or programs.
"Internal memory is full." appears.	So many files are resident in memory.	Move the device programs to your PC or delete unnecessary programs.
	So many application programs are installed.	Tap  > Settings > System > Remove Programs and remove unnecessary programs.
After scanning, data entry is not made.	The scan window is dirty or impaired.	Clean the scan window.
	No scanning program icon	Restart the scanning program by performing reset.
No sound is heard.	The volume is too low or no sound is heard.	Adjust the volume slider up or down. Deselect Off if selected. If the symptom persists, contact the retailer where you purchased the device or manufacturer.
	The speaker is clogged by foreign materials.	Remove foreign materials from the speaker.

Problem	Cause	Function
A fluid flowed into the device.		Promptly remove the battery and contact the retailer where you purchased the device or manufacturer.
The screen does not work and no operation is allowed.	A program has stopped working.	Press the reset button. If the symptom persists, contact with the purchased site or manufacturer.
The device does not accept scan input.	Unreadable barcode	Ensure the symbol is not defaced.
	Distance between scan window and barcode is incorrect.	Ensure the device is within proper scanning range.
	Battery is low.	Check the battery level. When the battery is low, the device automatically goes into suspend mode.
Spare battery is not charging.	Battery not fully seated in charging slot	Remove and reinsert the spare battery into the cradle, ensuring it is correctly seated.
	Battery inserted incorrectly	Ensure the contacts are facing down and toward the back of the cradle.
	Battery is faulty.	Verify that other batteries charge properly. If so, replace the faulty battery.

Connection

Problem	Cause	Function
The wireless LAN does not operate properly.	The wireless LAN is off.	Activate the wireless LAN.
	The IP cannot be received.	Set the values for SSID and IP and try again.
ActiveSync does not work.	There is no connection sign displayed even though connected.	Remove a USB cable from the device, reinstall ActiveSync, and try to reconnect it.
	ActiveSync is not installed.	Install the newest version of the program after downloading it from the Microsoft website.
	The program cannot be installed under Windows 7.	Install the program after downloading it from the Windows Mobile Device Center in the Microsoft website.
No connection to the PC through a USB cable	No connection	Check whether your PC and the device are all turned on.
	In case of using a USB hub	Check the USB cable connection status. When connecting between the device and PC through a USB cable, do not use a USB hub but connect them directly.
	Connection settings problem	Tap  > Settings > Connections > USB to PC > uncheck Enable advanced network functionality .

10. Specifications

Physical Characteristics	
Dimensions	163 x 78 x 36.5 / 163 x 72 x 35 mm (Grip)
Weight	363 g (battery included)
Display	3.5" QVGA TFT LCD (240 x 320)
Touch Panel	Wire Analog Resistive Window Touch Panel/ITO Strengthened Glass
Backlight	LED backlight
Expansion Slot	microSD (up to 32 GB) 2-SIM (1 SIM / 1 SAM option)
Notifications	Multicolor LED / Vibrator
Performance Characteristics	
CPU	PXA 320 806 MHz (Marvell)
OS	Windows Mobile Embedded Handheld 6.5
Memory	256 MB RAM / 512 MB NAND Flash (or 512 MB/1 GB max)
Battery	4000 mA / h-3.7 V (Lithium-ion)
Backup Battery	150 mAh / Li-polymer
Interface	USB 2.0 Client, RS-232C & Ethernet (via cradle)
Use Environment	
Temperature	Operating -20 °C ~ +55 °C Storage -40 °C ~ +70 °C
Humidity	93 % at +50 °C
Drop Test	1.8 m high
IP rating	IP65
Wireless Radio	
WAN	GSM/GPRS/EDGE (850/900/1800/1900 MHz) UMTS/WCDMA/HSPA+ (800/850/900/1900/2100 MHz)
WLAN	IEEE 802.11 a/b/g/n
Bluetooth	V2.1+EDR, Class II
GPS	Internal GPS
HF-RFID	HF 13.56M ISO/IEC 14443A/B (MIFARE), ISO15693
UHF	900 MHz ISO18000-6C, EPC Global Class1/GEN2
General Option	
Scanner	1D/2D Scanner
Camera	3.0M AF camera with LED flash
Keypad	38 key numeric keypad 53 key qwerty keypad (option)
Sensor	Accelerometer

11. Regulatory Compliance Information

European Conformity Statement



Hereby, CATCHELL, INC., certifies that CW31 is in compliance with the essential requirements and other relevant provisions of R&TTE Directive 19995/5/EC.

The CE marking certifies that CW31 meets EU health, safety, and environmental requirements to ensure user safety.

RoHS Statement



This device conforms to RoHS (Reduction Of Hazardous Substance) Europe Union regulations that set maximum concentration limits on hazardous materials used in electrical and electronic equipment.

Pb, Hg, Cd, Cr(VI), PBBs and PBDEs could not be detected over the limit defined by the European Directive 2002/95/EC.

Battery Information

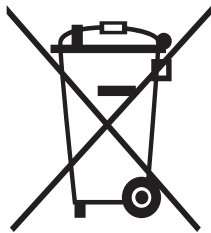

The battery pack used in this device may ignite, create a chemical burn hazard, explode, or release toxic materials if mistreated. Make sure to keep the batteries out of reach of children or pets and do not incinerate, disassemble, heat or short circuit.

If the device is wet, do not place it near any heat sources. Heating batteries may cause an explosion, deformation or fault.

This device is equipped with a Lithium-Ion battery pack, which will discharge after an extended period of non-use. When the battery reaches the end of useful life, it should be disposed of by qualified recycler or hazardous materials handler according to local recycling guidelines. Do not mix this battery with the solid waste stream.

Laser Safety Statement



This device contains internally a Visible Laser Diode (VLD) and LED whose emissions do not exceed the maximum limits as set forth in the regulation.

- IEC 60825-1 / EN 60825-1 - Class 2 (1 mW, 630-680 nm)
- IEC 60825-1 / EN 60825-1 - Class 1 LED Device

The scanner is designed so that there is no human access to harmful laser and LED light during normal operation, user maintenance or during prescribed service operations.

The laser safety warning label required is located on the back of the device. This label shall be adhered to CW31 with laser scanner module only.



12. Customer support

Limited Warranty

CATCHWELL, Inc. ("CATCHWELL") warrants to the original end user purchaser ("You") that for the Warranty Period listed below, the Device (excluding any third party software) will be free of defects in materials and workmanship under normal use.

You must have proof of purchase before returning defective devices to CATCHWELL. Returned devices must be shipped prepaid and packaged appropriately to prevent any damage in transit, and it is recommended that the package should be insured or sent by a carrier who provides a tracking number of the package. CATCHWELL is not responsible for any Device that is lost or damaged in transit. If CATCHWELL ships a replacement device to you before receiving the original device and you fail to return the original device to CATCHWELL within thirty (30) days from the date the warranty service authorization is issued, CATCHWELL will charge you the current manufacturer's suggested retail price of such device. Your exclusive remedy and CATCHWELL's entire liability under this warranty will be for CATCHWELL at its option to repair or replace the Device or refund your purchase price less any rebates. CATCHWELL does not warrant against loss of any data or images (including data stored on Device returned to CATCHWELL for service), and assumes no liability for such loss.

ALL IMPLIED WARRANTIES OR CONDITIONS OF MERCHANTABILITY, SATISFACTORY QUALITY OR FITNESS FOR A PARTICULAR PURPOSE ARE LIMITED TO THE DURATION OF THE APPLICABLE EXPRESS WARRANTY. ALL OTHER EXPRESS OR IMPLIED CONDITIONS, REPRESENTATIONS AND WARRANTIES, INCLUDING ANY IMPLIED WARRANTY OF NON-INFRINGEMENT, ARE DISCLAIMED TO THE FULLEST EXTENT PERMITTED BY LAW.

There are inherent risks associated with any biometric sensor technology and security safeguard, including encryption technology, and biometric sensors and security safeguards, by their nature, are capable of circumvention. CATCHWELL cannot, and does not, guarantee that your data will not be accessed by unauthorized persons, and CATCHWELL disclaims any warranties to that effect to the fullest extent permitted by law. You should not use this device to protect sensitive data such as financial information or for accessing corporate networks.

Some jurisdictions do not allow limitations on how long an implied warranty lasts or at all, so the above limitation may not apply to you. This warranty gives you specific legal rights, and you may also have other rights, which vary by jurisdiction.

This limitation does not affect your statutory rights.

All third party software provided with the Device is provided "AS IS". You assume the entire risk as to the quality, performance, accuracy and effect of such software, and should it prove defective, you, and not CATCHWELL, assume the entire cost of all necessary servicing or repair.

TO THE EXTENT NOT PROHIBITED BY LAW, IN NO EVENT WILL CATCHWELL BE LIABLE FOR ANY LOST IMAGES, DATA, REVENUE OR PROFIT, OR FOR SPECIAL, INDIRECT, CONSEQUENTIAL, INCIDENTAL OR PUNITIVE DAMAGES, HOWEVER CAUSED REGARDLESS OF THE THEORY OF LIABILITY, ARISING OUT OF OR RELATED

TO THE USE OF OR INABILITY TO USE THE DEVICE, EVEN IF CATCHWELL HAS BEEN ADVISED OF THE POSSIBILITY OF SUCH DAMAGES. IN NO EVENT WILL CATCHWELL'S LIABILITY EXCEED THE AMOUNT PAID BY YOU FOR THE DEVICE.

The foregoing limitations will apply even if any warranty or remedy provided under this Agreement fails of its essential purpose.

Device	Warranty Period
CATCHWELL CW31	15 months from the manufactured date
Handheld Device	

If you need assistance installing or troubleshooting your device, please contact the retailer where you purchased the device or service center.

Headquarters

- **Company Name:** Catchwell Inc.
- **Address:** B-405 BundangTechnopark Yatap-dong Bundang-gu Seongnam-si, Republic of Korea
- **TEL:** +82-31-788-5300
- **FAX:** +82-31-788-5222
- **E-MAIL:** catchwell@catchwell.com

Index

1-slot cradle 8
4-slot cradle 8

A

Accessories 8
ActiveSync 15
Add to Speed Dial 54
Adjusting volume 30

B

Barcode Setting 35
Battery level indicators 22
Bluetooth 39

C

call 50
Call and signal strength indicators 21
Call history 55
Camera 46
Charging the battery 13
Connection 15
Connection status 21
contacts 52

D

DashBoard 37
Decode Only 43
Device Information 33

E

Emergency call 55
External I/O 36

F

Front and Side View 9
Function buttons 25

G

GPS Navigation 64

H

hand strap 17
Hard reset 31
Home screen 19
HotKey 26

I

Image Decode 43
Image decoding 43
Image Only 43

K

KeyMap 27

L

Laser scanning 42
LED Indicator 30
Locking or unlocking the screen 32

M

microSD card 11
Modem Band Setting 38
Multiscan Mode 43

N

Numeric keypad 24

P

Pictures & Videos 48
power 14
Power Button Setting 35

Q

Quick Manager 33
QWERTY keypad 24

R

Rear, Top, and Bottom View 10
Rotation 38

S

Scanning considerations 42
SCU 58
SIM card 12
SIM Selector 12, 49
Snap on I/O 8
Soft reset 31
Sound status indicators 22
spare battery 13
Startup Manager 34
stylus 18

T

Taking a picture 45
Task bar 23
Text input 24
Title bar 21

U

USB to PC 15

V

Video recording 46
Virtual keypad 24

W

Wireless Manager 16, 49
WLAN 57
WZC 62

CATCHWELL

CATCHWELL INC.

B-405 Bundang Techno Park, 148 Yatap-dong, Bundang-gu, Seongnam-si, Gyeonggi-do korea

Tel: +82-31-788-5300 | Fax: +82-31-788-5222

Email: catchwell@catchwell.com | Homepage: www.catchwell.com